



## Service-Pro Series SPD50-V Order Form

Quote/Order# \_\_\_\_\_

Company Name: \_\_\_\_\_

Attention: \_\_\_\_\_

Email: \_\_\_\_\_

Phone#: \_\_\_\_\_

Job Name: \_\_\_\_\_

### PAIR

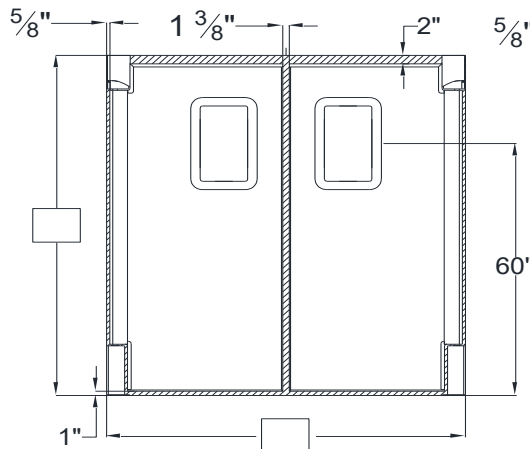

### SINGLE

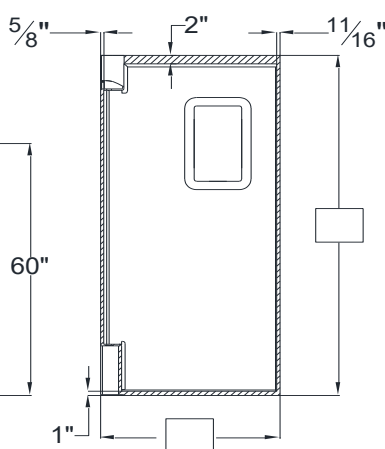

### CROSS SECTION

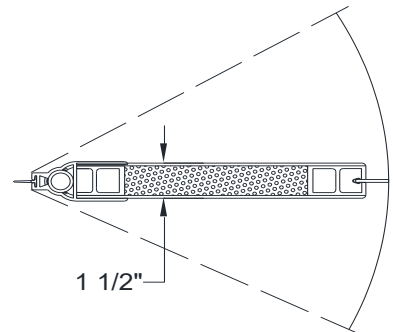

Fill in Opening Size in the Blanks Provided Above

**STANDARD SPECIFICATIONS:** Door body is 1-1/2" thick with high impact, thermoplastic material surface, bonded to a high strength PVC frame with a foam core. Provided with full perimeter seal. Variety of window frame sizes available. Door assembly includes the Retailer V-Cam Hardware.

**INSTALLATION DETAILS:** Jambs must be plumb and square. Minimum double 2 x 4 inch wood construction or equivalent. Hollow metal jambs should be reinforced at hinge locations.

#### **SPECIFIC DETAILS FOR DOOR CONSTRUCTION:**

HANDING: ☐ Left ☐ Right ☐ Pair

DOOR COLOR: ☐ Forest Green ☐ Cadet Blue ☐ White ☐ Metallic Gray ☐ Cloud Gray  
☐ Chocolate Brown ☐ Red ☐ Medium Brown ☐ Royal Blue ☐ Navy ☐ Black ☐ Beige  
☐ Off White ☐ Fudge Brown ☐ Gray

FRAMED WINDOW: ☐ 10 X 16 ☐ 10 X 30 ☐ 12 X 18 ☐ 16 X 16 ☐ 17 X 23  
☐ Other: \_\_\_\_\_

PLATE: Specify Height: \_\_\_\_\_  
Color/Material: ☐ ABS - Black ☐ ABS - Same As Door ☐ Stainless Steel ☐ Other \_\_\_\_\_

BUMPER: Standard Black Spring, Height: ☐ 12 ☐ 18 ☐ 24 ☐ 30 ☐ 36 ☐ 42  
Aluminum Bumper Strip: ☐

OTHER SPECIFICATIONS: \_\_\_\_\_

APPROVED BY: \_\_\_\_\_

DATE: \_\_\_\_\_