



## Service-Pro Series SPD-50-V Order Form

Quote/Order# \_\_\_\_\_

Company Name: \_\_\_\_\_

Attention: \_\_\_\_\_

Email: \_\_\_\_\_

Phone#: \_\_\_\_\_

Job Name: \_\_\_\_\_

**PAIR**

**SINGLE**

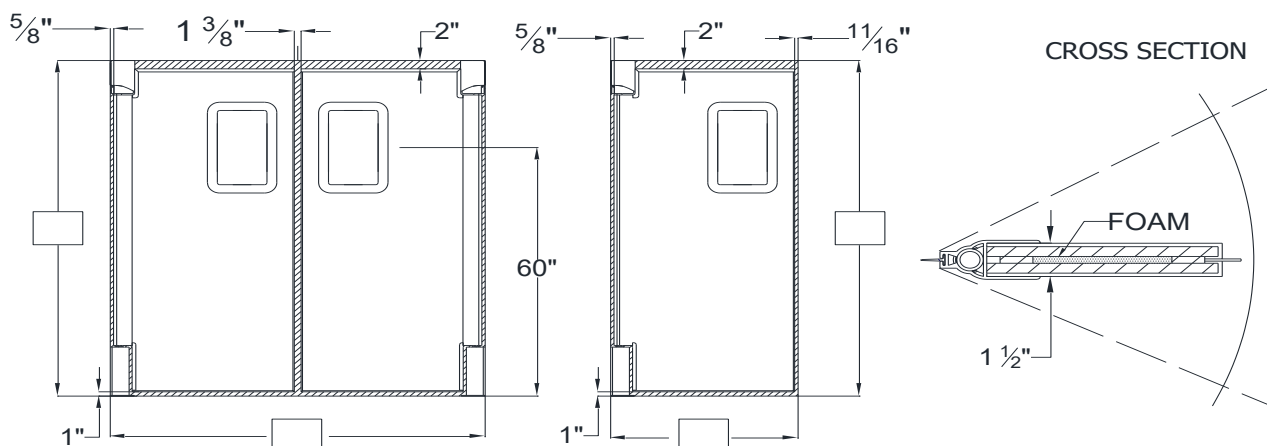

**Fill in Opening Size in the Blanks Provided Above**

**STANDARD SPECIFICATIONS:** Door body is 1-1/2" thick composite wood core with insulating foam inserts, metal clad with either stainless steel or aluminum. Provided with full perimeter seal. Variety of window frame sizes available. Door assembly includes the Retailer V-Cam Hardware.

**INSTALLATION DETAILS:** Jambs must be plumb and square. Minimum double 2 x 4 inch wood construction or equivalent. Hollow metal jambs should be reinforced at hinge locations.

**SPECIFIC DETAILS FOR DOOR CONSTRUCTION:**

HANDING:     ☐ Left     ☐ Right     ☐ Pair

DOOR FINISH:     ☐ Stainless Steel     ☐ Aluminum

FRAMED WINDOW: ☐ 10 X 16   ☐ 10 X 30   ☐ 12 X 18   ☐ 16 X 16   ☐ 17 X 23  
☐ Other : \_\_\_\_\_.

PLATE:     Specify Height: \_\_\_\_\_.  
Color/Material: ☐ Stainless Steel   ☐ Galvanized Steel   ☐ ABS   ☐ Other \_\_\_\_\_.

BUMPER:     Standard Black Tear Drop Polyethylene Height: ☐ 12   ☐ 18   ☐ 24   ☐ 30   ☐ 36   ☐ 42  
Aluminum Bumper Strip: ☐

OTHER SPECIFICATIONS: \_\_\_\_\_.

APPROVED BY: \_\_\_\_\_

DATE: \_\_\_\_\_

orders@curtronproducts.com

Curtron Products

800.833.5005