



External Motor Driven
SCREEN-PRO™
All Season Roll-Up Doors

**STAND-OFF MOUNTING METHOD
INSTALLATION INSTRUCTIONS**



READ THIS FIRST

Carefully examine the crate(s) for damage before opening. If the carton is damaged, immediately notify shipping company. Open the carton(s) and remove all protective packaging. Retain the shipping carton(s) until the unit(s) is installed and properly operating. TMI, LLC is not responsible for delayed or late claims.

Serial No: _____ Model #: _____ Date Purchased: _____

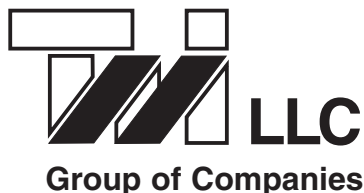

Warning

To Reduce the Risk of Fire, Electrical Shock, or Injury, Observe the Following:

- Use this unit only in the manner intended by the manufacturer. If you have any questions, contact the manufacturer.
- Installation work must be done by a qualified person(s) in accordance with all applicable codes and standards.
- When cutting or drilling into wall or ceiling, do not damage electrical wiring and other hidden utilities.
- All electrical work should be performed in accordance with local and state building codes. If you are in doubt of proper wiring installation, we recommend acquiring the services of a certified electrician.

Read and Save These Instructions

Please read the "READ THIS FIRST" note on the front cover of this manual before proceeding.

IMPORTANT NOTE

If the Screen-Pro was ordered with optional electrical components and accessories (door switch, control panels, mounting brackets, etc), the accessories may be found in an additional box. Check all of the boxes before disposing

TYPES OF DOORS

**PLAIN
DOORWAY
OPENING**

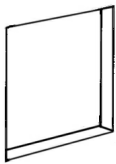

OVERHEAD DOOR

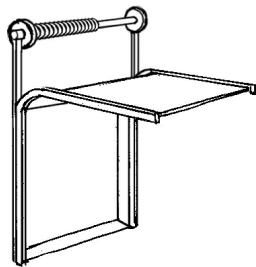

**ROLL-UP
DOOR**

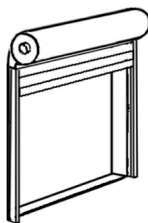

There are a variety of doors used at both industrial and commercial facilities. Each has its specific opening/closing mechanism. This Screen-Pro unit has been shipped with hardware to accommodate a Stand-Off Mounting Method. It should be mounted in front of any rails or guide tracks and centered on the doorway opening. Also, the Screen-Pro guide tracks should be on the outside of any rails or tracks used with the security (regular) door.

SCREEN-PRO COMPONENTS

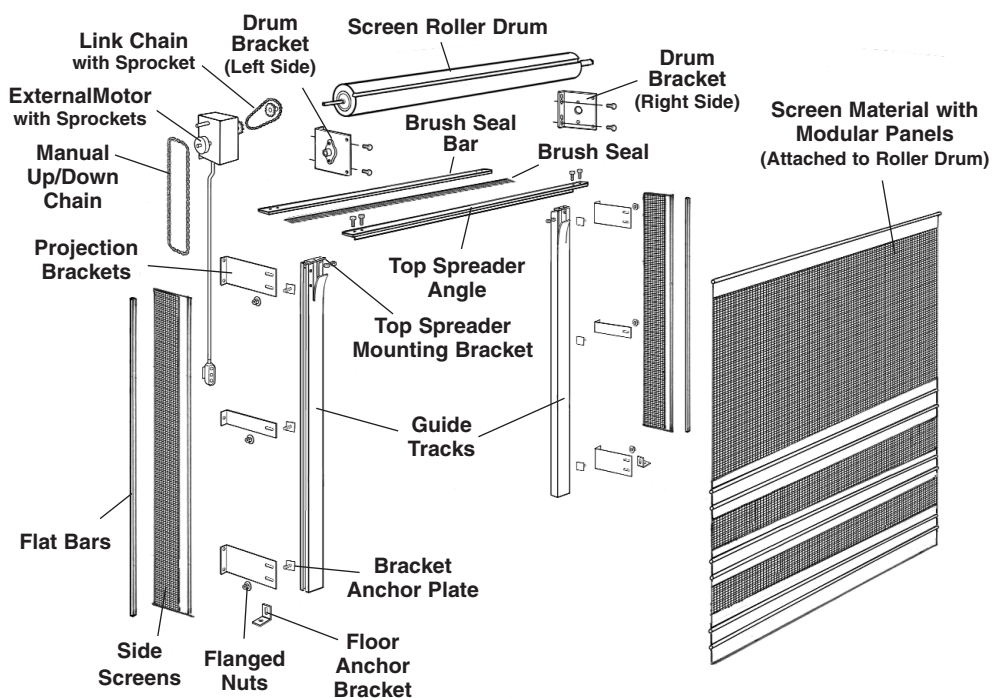

REQUIRED TOOLS

It is recommended that two people install the door together.

The following tools will be needed for installation:

- Carpenter's Level (Min. 4' Length)
- Carpenter's Square
- Hammer Drill
- Masonry Drill Bit
(For 3/8" Diameter Anchors)
- 3/8" Diameter and Various Wall Anchors
- Assorted Shim Stock
- Socket and Wrench Set
- Hand Tools
- Four Bar Clamps (36" Long)
- Two Ladders
- Forklift (Supplied by Dealer or Customer)

STEP 1

Lay the basic components in front of the doorway opening.

STEP 2

Slide the Brush Seals into the edge groove of the each Brush Seal Retainers Bars.

A. 2" Brush goes into 1" (45°) Retainer

B. 3" Brush goes into 2" Straight Retainer

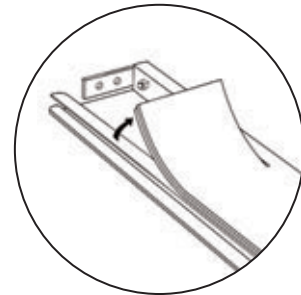
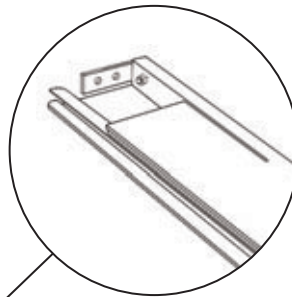
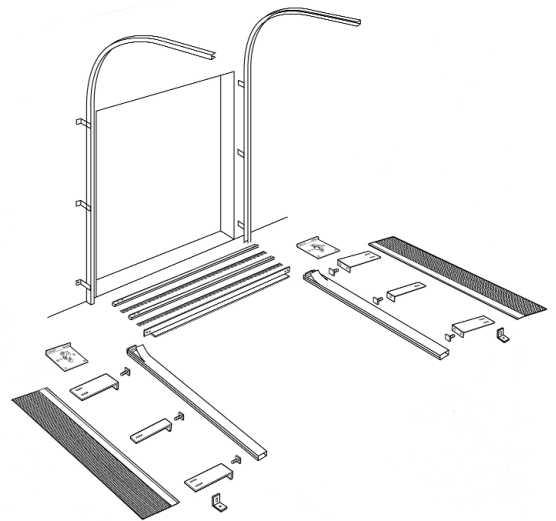
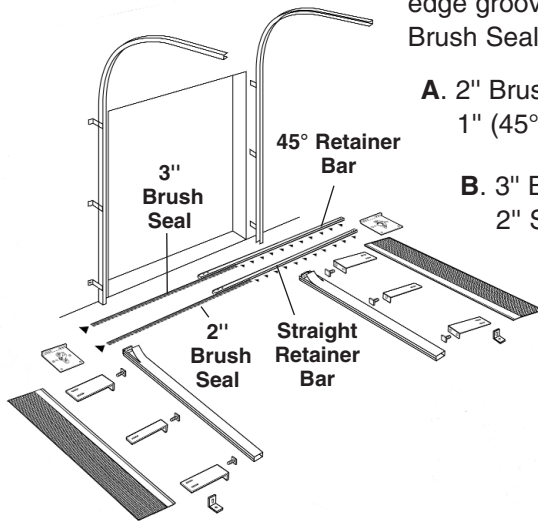

STEP 3

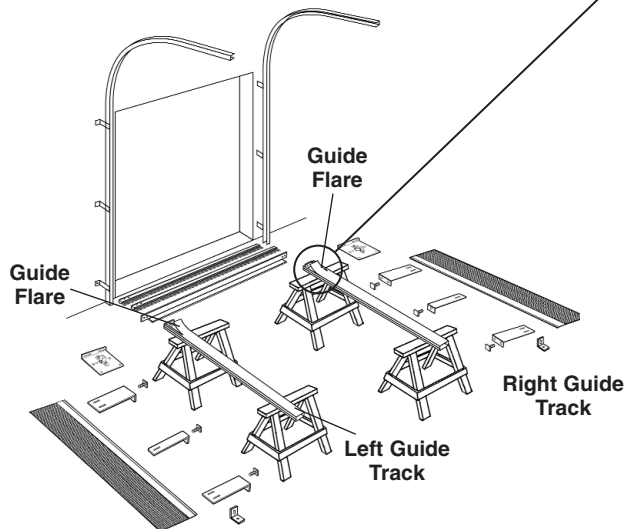

Using work horses will make the assembly process easier although it is not essential. Place the Guide Tracks on the horses with the Guide Flare Plate facing up.

IMPORTANT

The Guide Track Flare Plate ships flat and must be bent out 1 1/2" before any assembling takes place.

NOTE: There is a left and a right Guide Track.

STEP 4

Slide each Side Screen into the groove that is at the bottom outside edge of the Track Guides.

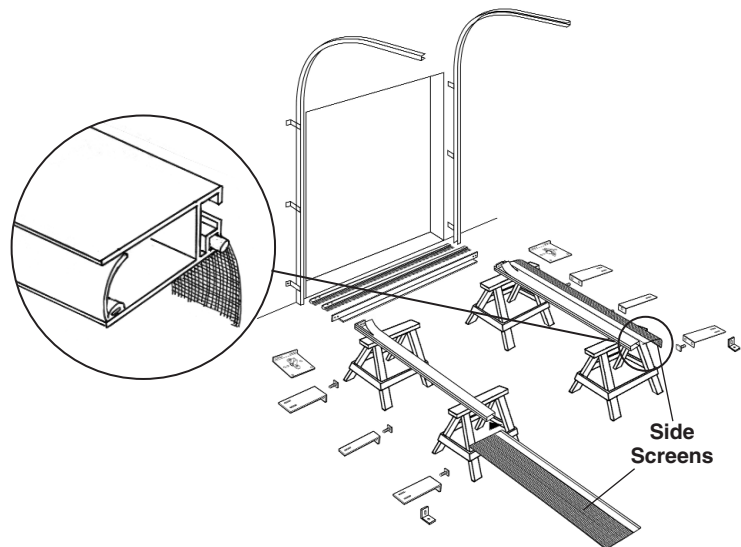

STEP 5

Slide the Bracket Anchor Plates into the guide channel that is on the outside edge of the Track Guides. There are 10 Anchor Plates, 5 for each side on a 10' high door.

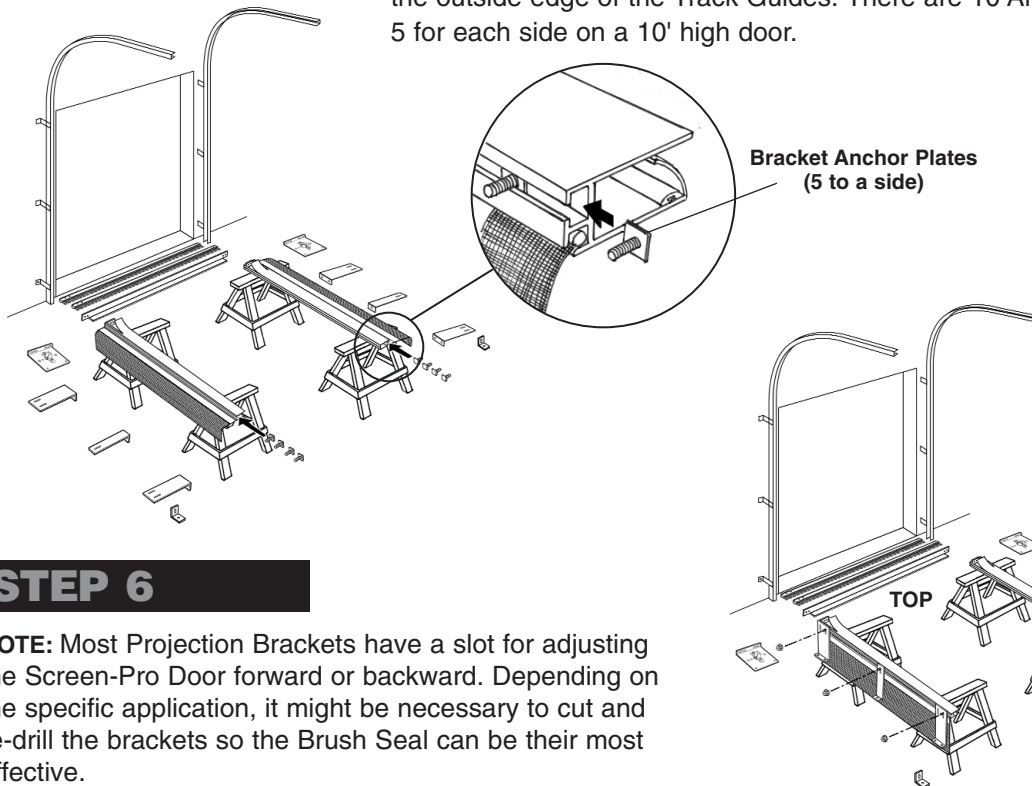

STEP 6

NOTE: Most Projection Brackets have a slot for adjusting the Screen-Pro Door forward or backward. Depending on the specific application, it might be necessary to cut and re-drill the brackets so the Brush Seal can be their most effective.

Place a Projection Bracket on each Bracket Anchor Plate. The top and bottom braces have 2 slots. All 5 slots must be used. **IMPORTANT:** The Wall Mounting Lip should be facing outward. The top edge of the Top Projection Bracket should be mounted 8" from the top of the Guide Track. The bottom edge of the Bottom Bracket should be even with the bottom of the track and the single slotted brace should be centered on the Guide Track

Place a Flange Nut on each Bracket Anchor Plate to secure the Bracket and hand tighten. Use a square to make sure that each Projection Bracket is perpendicular to the Guide Track. Then tighten with a wrench.

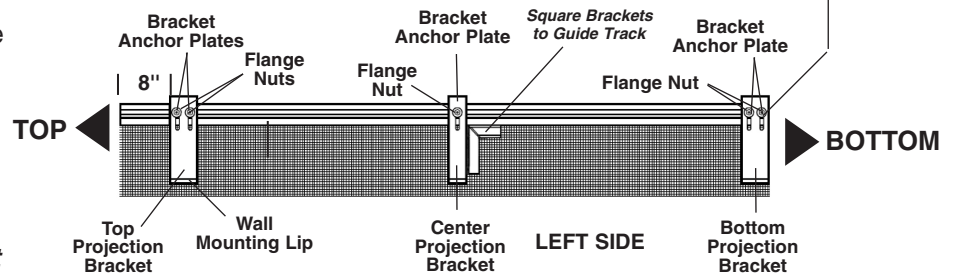

NOTE: Do not place Flange Nut on bottom Anchor Plate until the Floor Anchor Angle is in place, Step 7.

STEP 7

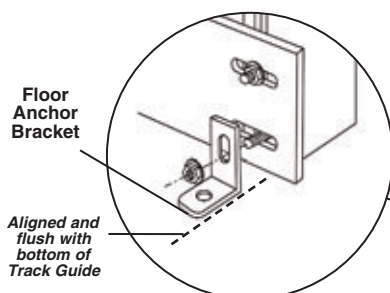

Next, attach a Floor Anchor Bracket to the bottom of each Guide Track using the Bracket Anchor Plate. Place the oval hole over the bolt and tighten with a flange nut. The Floor Anchor Bracket should be at right angles with the Track Brace and flush with the bottom of the Guide Track.

STEP 8

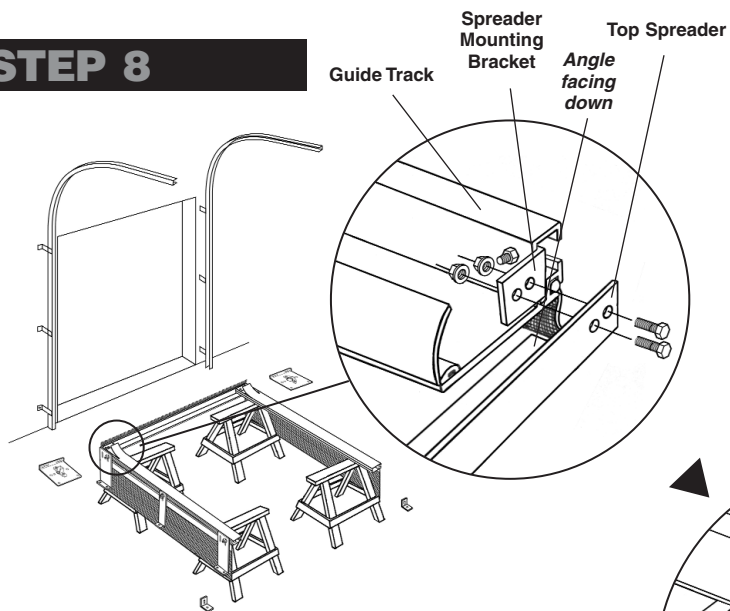

Attach the Top Spreader to the top of the Guide Track using the Spreader Mounting Bracket. Make sure the back of the Spreader Angle is facing down and toward the wall. Place the Retainer Bar that has the 2" Brush Seal attached on top of the Spreader with the brush facing toward the screen door. Then place the Retainer Bar with the 3" Brush Seal on top of the 2" Brush Bar facing the existing door. Use 2 bolts and flange nuts on each side to secure all the components..

Use the supplied Self-Tapping Sheet Metal Screws to attach the Brush Retainer Bars.

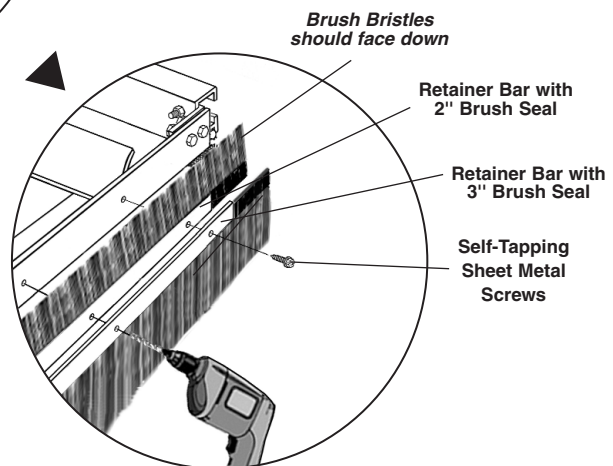

STEP 9

Attach just the left Drum Brackets to the top of each Guide Track using 5/16" x 1-1/4" bolts with flange nuts. The Mounting Plate Flange should be facing inward toward the center of the unit

IMPORTANT: Use the bottom hole of each set of holes.

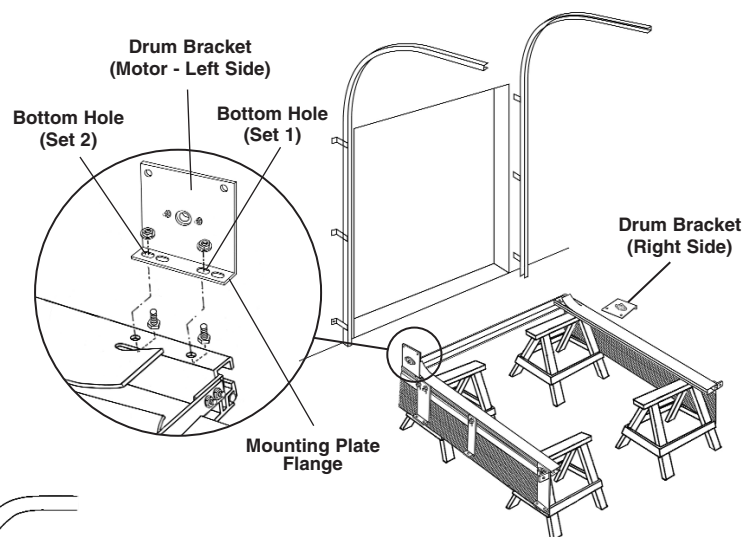

STEP 10

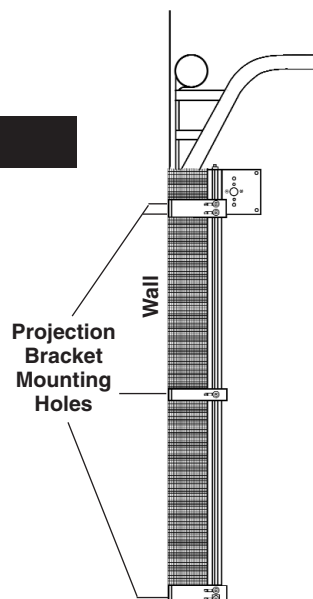

Using a helper, swing the assembly into place and center on the doorway opening. The bottom of Guide Tracks should be on the floor and the wall mounting holes on each Projection Bracket should be flush against the wall.

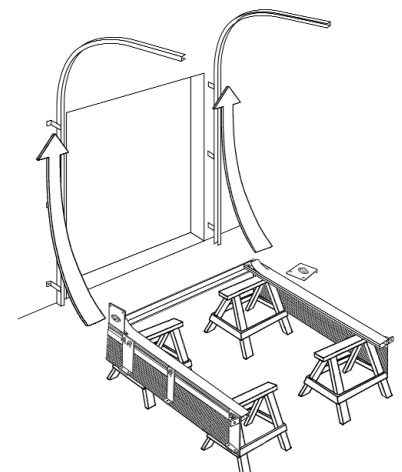

STEP 11

Once the assembly is centered, make sure that each Guide Track is plumb. Then mark the Projection Bracket mounting holes.

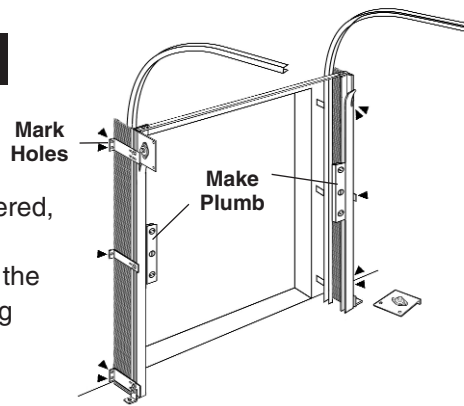

Remove assembly and drill all 10 holes. If you are mounting to a concrete wall or concrete block, wall, anchors will be necessary (not supplied).

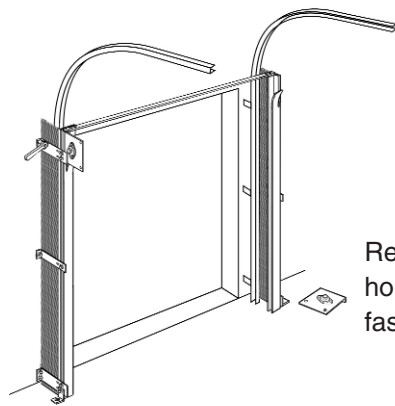

Replace the assembly and align all the mounting holes. Fasten the unit to the wall using appropriate fasteners for the mounting surface.

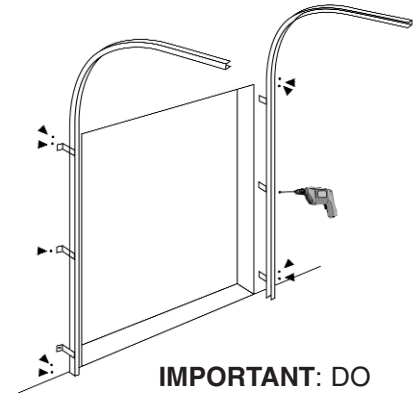

IMPORTANT: DO NOT mark or drill the Floor Anchor Bracket mounting holes. That is Step 16, Page 8.

STEP 12

The assembly might need to be moved toward the wall. The distance is determined by the space needed for any door handle(s) that are attached to the security door. First, slightly loosen all Bracket Anchor Plate Nuts. Then run the security door up the rail to make sure the handle(s) clear the top of Screen-Pro assembly. Once the adjustment is made, make sure the track is plumb and tighten all Bracket Anchor Plate Nuts.

At this point the Side Screens might need to be trimmed using scissors or a utility knife. The Screen should be 3" wider than the distance from the Guide Track to the wall. Carefully place the excess material against the wall, fold it toward the doorway opening and secure it with the supplied aluminum bar.

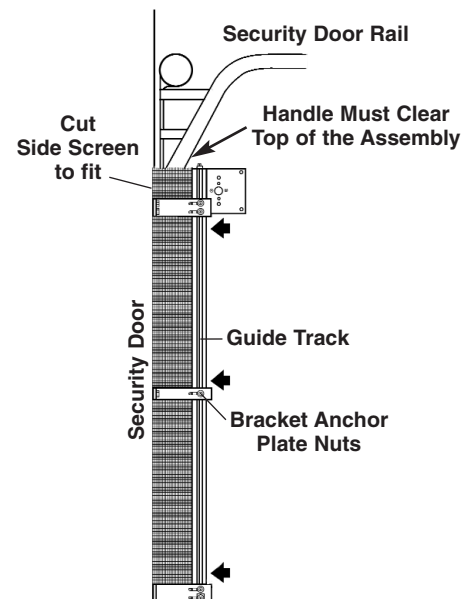

TIP: It is much easier to do this procedure when the security door is open.

STEP 13

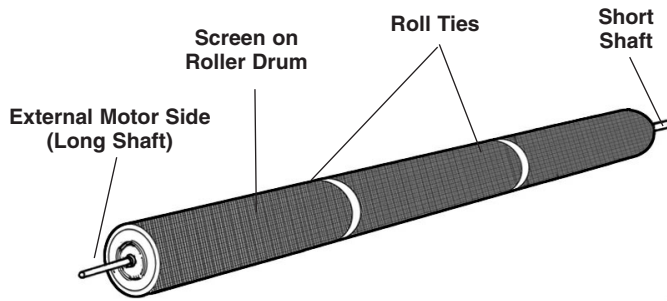

First, place the Screen Roller Drum into the Left Drum Mounting Plate. The Longer Shaft should be to the left and the Shorter Shaft to the right. Also the Bottom Edge of the Screen should be facing down.

NOTE: External Motor comes standard on left side, unless ordered for right side.

Then, place the right Drum Mounting Plate over the Drum Shaft.

WARNING

DO NOT remove the Roll Ties until the Roll Tube is secured to both Drum Mounting Plates.

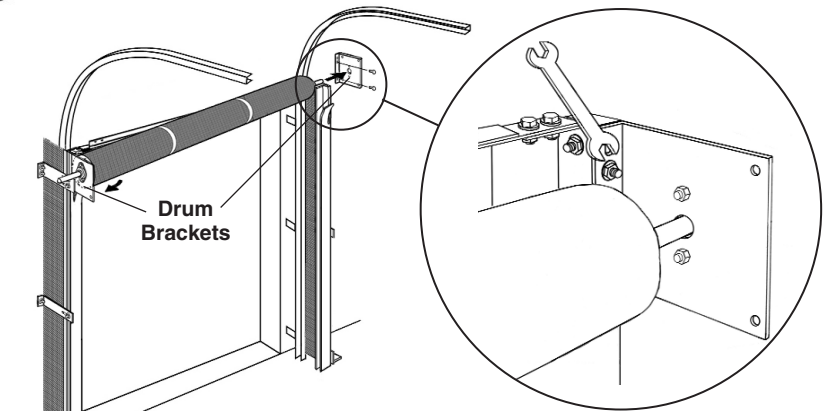

Next, attach the Drum Mounting Plate to the right Guide Track using 5/16" x 1-1/4" bolts with flange nuts. Tighten nuts with open end wrench.

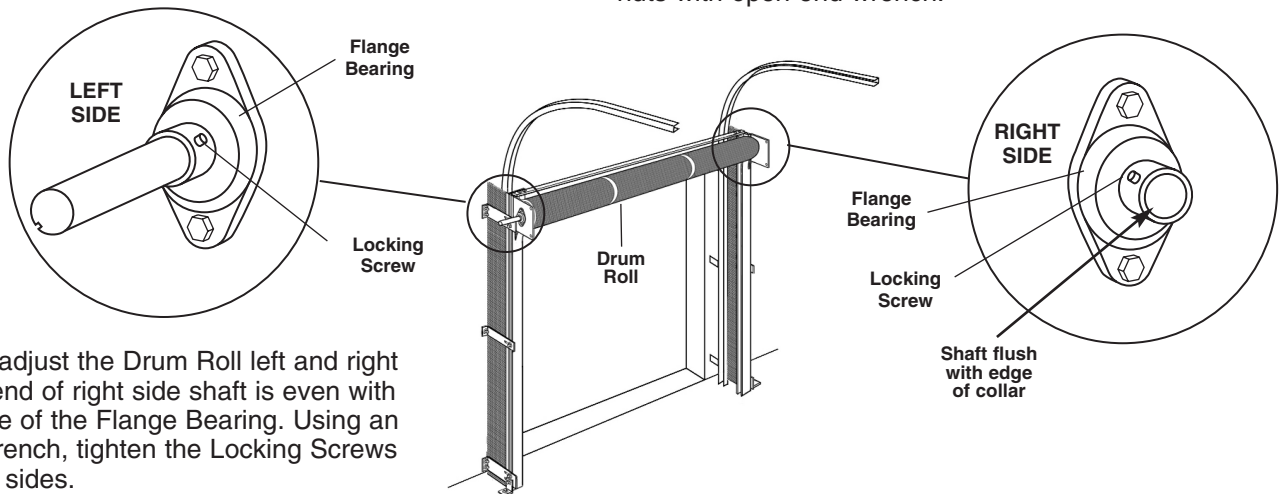

Finally, adjust the Drum Roll left and right so the end of right side shaft is even with the edge of the Flange Bearing. Using an Allen wrench, tighten the Locking Screws on both sides.

STEP 14

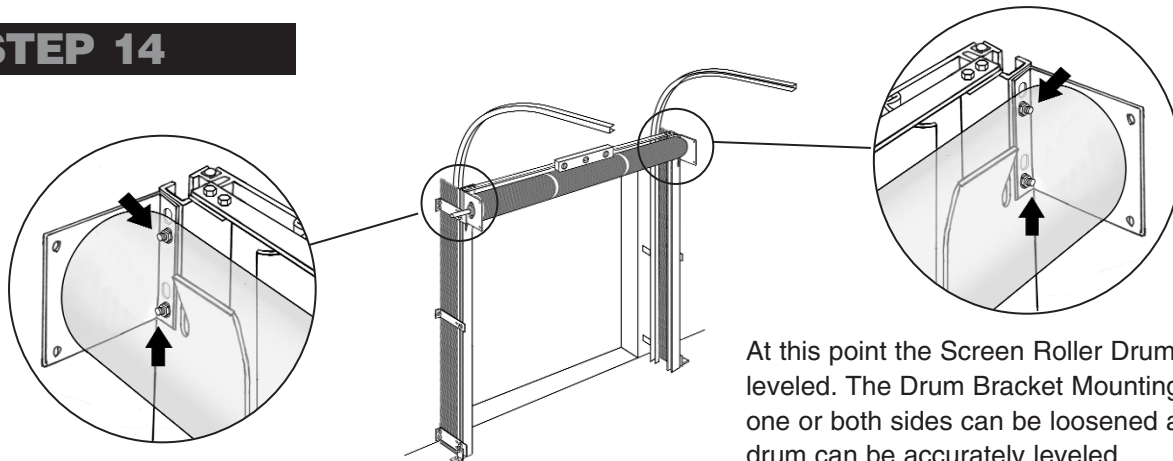

At this point the Screen Roller Drum must be leveled. The Drum Bracket Mounting Bolts on one or both sides can be loosened and the drum can be accurately leveled.

STEP 15

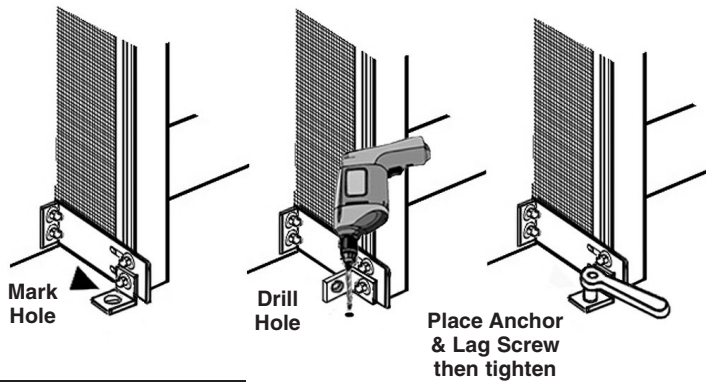

Next, the Screen-Pro should be fastened to the floor using the Floor Anchor Angles which were attached to the Bottom Track Braces (left & right) in Step 11. First, mark the holes. Second, drill the holes. Finally, place the screw anchors and secure with a lag screws.

STEP 16

Mount the motor and attach the sprockets, one to the door shaft and the other to the shaft on the motor.

IMPORTANT: *Refer to the Motor Instruction Manual for more information.*

Connect the 2 sprockets with the link chain.

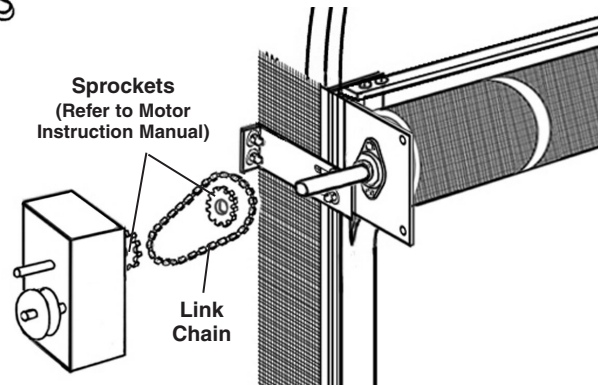

STEP 17

Then carefully cut the Roll Ties without cutting the screen. Slip the bottom edge of the screen into the Guide Tracks. Place the leading edge in front of the Rubber Gasket to create a seal.

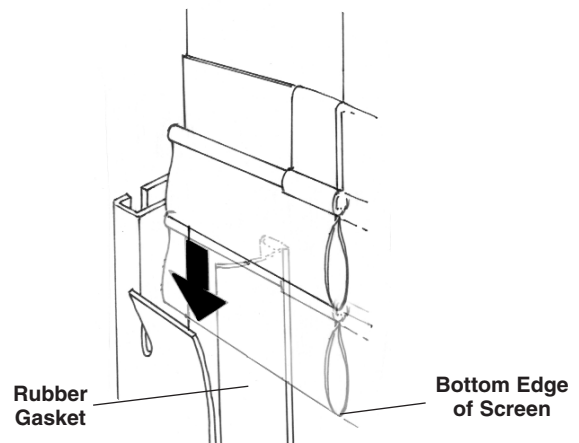

STEP 18

Installing Motor & Control and Wiring of Both

Refer to Motor Installation Booklet and Wiring Instructions that are included with your door.

NOTES

800-888-9750

TMI, LLC • 5350 Campbells Run Road • Pittsburgh, PA 15205-9738 • 412.787.9750
Fax: 412.787.3665 • Web Site: www.tmi-pvc.com • E-Mail: customer-service@tmi-pvc.com