

Quantity:  Model #:   STD  IND Finished Opening Size:   Quote  Order PO #:

Color:  SPECIFY:  Left Hand Panel  Right Hand Panel

**BUMPER/KICK PLATE**

Teardrop Bumper

Height

Color

Kick Plate

Stainless Steel

Height

Polyethylene

Height

Color

**BUMPER/KICK PLATE (DUTCH)**

Teardrop Bumper

Height

Color

Kick Plate

Stainless Steel

Height

Polyethylene

Height

Color

**FASTENERS**

Steel Jamb

Wood Jamb

**SEALS**

Top Seal

Standard

Extended - GAP

Upper Hinge Seal

Lower Hinge Seal

**AVAILABLE OPTIONS**

Lower Hinge Guard

8"  11"

Roto-Molded

Aluminum

Base Plate

Stainless Steel

Spring Assist

Low Rise HW

No Rise HW

Hold Open

Weld Plate

Locking Device

Cane Bolts

Top  Bottom

INDUSTRIAL DOORS WITH BUMPERS,  
SEE ATTACHMENT FOR  
RECOMMENDED OR REQUIRED  
POST LOCATIONS.

**GASKETING**

Full

Partial

Front

Back

Bottom

**HARDWARE**

90 x 90

180 x 90

**WINDOW**

Single Pane

Double Pane

Window Sizes	
Panel Width	Window
24" & 27"	10 1/2" x 22 1/2"
30"	14 1/2" x 22 1/2"
32"	16 1/2" x 22 1/2"
34"	18 1/2" x 22 1/2"
36" thru 48"	20 1/2" x 22 1/2"
54" & 60"	22 1/2" x 22 1/2"

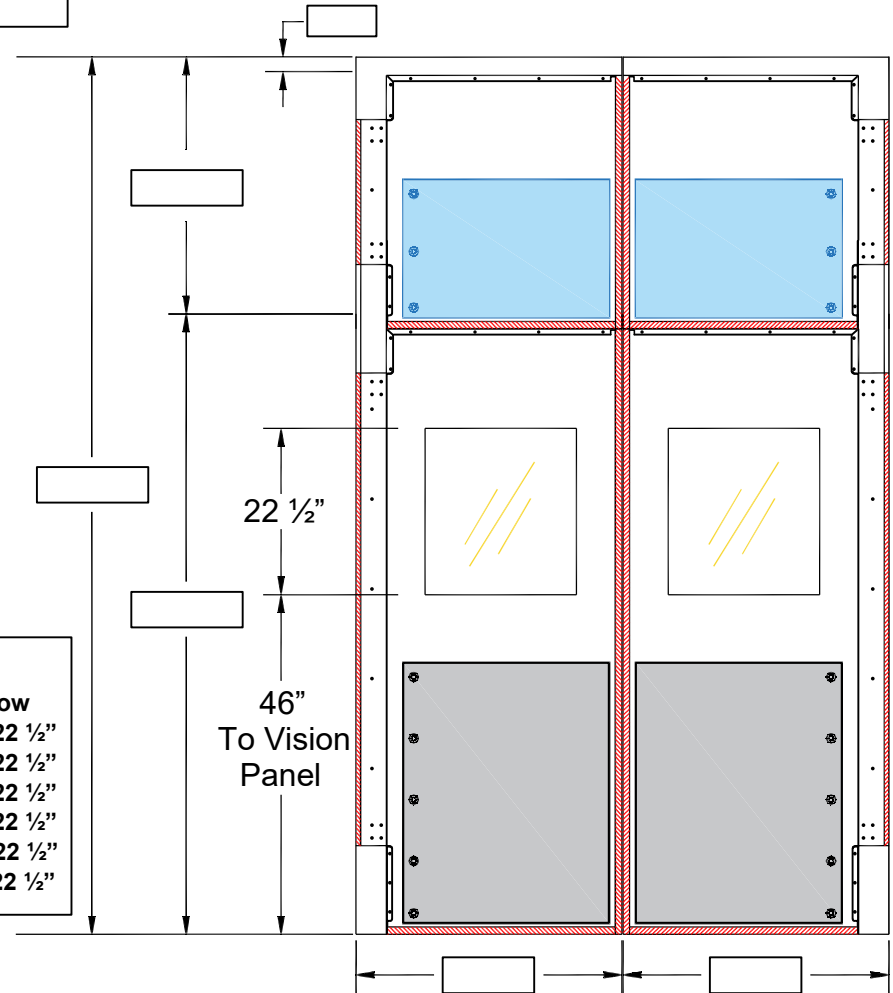
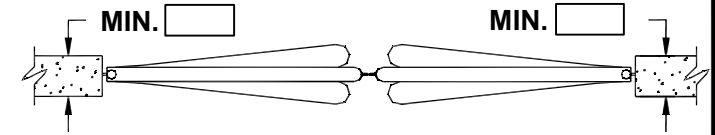

NOTES:

DATE

World's Leading Manufacturer of Traffic Doors  
Cincinnati Ohio, and Redmond Oregon • www.chasedoors.com  
Phone Toll Free: 1-800-543-4455 • FAX: 1-800-978-6570

CUT DURULITE - DOUBLE DUTCH DOOR SHOP DWG

TO:  
JOB: