

Chase Doors

*Single Swing or Double Swing
Coldguard™ Door*

Parts Manual



6. PARTS LIST

The Parts List is provided for your convenience when ordering replacement parts. Use of the model and serial number of your door when ordering parts will expedite shipment of required parts and avoid unnecessary correspondence.

HOW TO ORDER

1. STATE PART NUMBER & DESCRIPTION
2. STATE MODEL NUMBER
3. STATE SERIAL NUMBER
4. STATE ACTUAL WIDTH IN CLEAR AND HEIGHT IN CLEAR

		
Chase Doors		
ColdGuard		
MODEL# SSW		
HEATER VOLTAGE:	WATTS:	HZ:
SERIAL#		
TAG#		
800.543.4455 www.chasedoors.com		
www.coldstoragedoorsonline.com		

ColdGuard SSW

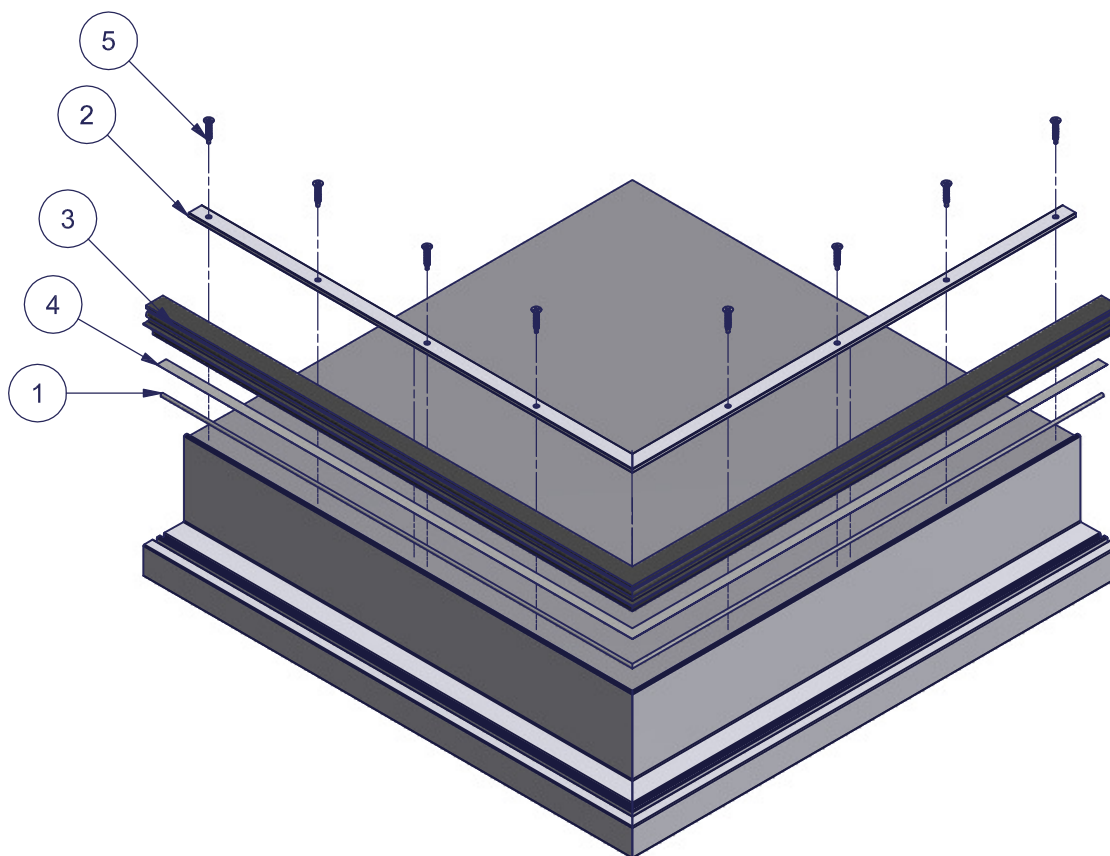

Parts List			
ITEM	QTY	PART NUMBER	DESCRIPTION
1	1		HEATER WIRE, OPTIONAL
2	1	S11140	CLAMP STRIP
3	1	S18035	GASKET, #10-130, BLACK
4	1	S18498	TAPE, ALUMINUM FOIL TAPE, #5501, 1"
5	8	S18403	SCREW, TEK FH #6 X 3/4, PHIL, S.S.

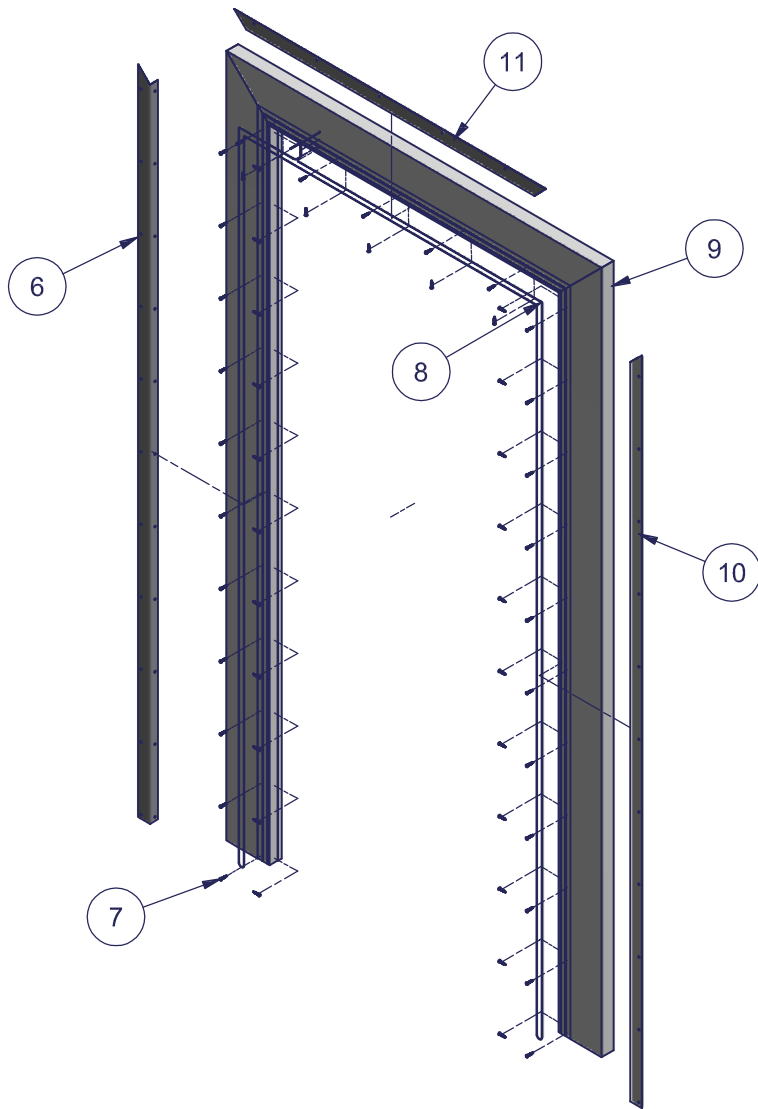

Parts List			
ITEM	QTY	PART NUMBER	DESCRIPTION
6	1	S5600 LEFT	LEFT MAGNETIC FRAME STRIP AND HEATER WIRE COVER
7	VARIES	S18404	SCREW, TEK PH, #6 X 3/4, PHIL S.S.
8	1		HEATER WIRE, SEE INFORMATION REQUIRED BELOW
9	1		FIBERGLASS DOOR FRAME, SEE INFORMATION REQUIRED BELOW
10	1	S5600 RIGHT	RIGHT MAGNETIC FRAME STRIP AND HEATER WIRE COVER
11	1	S5600 TOP	TOP MAGNETIC FRAME STRIP AND HEATER WIRE COVER
12	1	S5600 BOTTOM	BOTTOM MAGNETIC FRAME STRIP AND HEATER WIRE COVER (NOT SHOWN)

PLEASE PROVIDE SERIAL NUMBER:_____

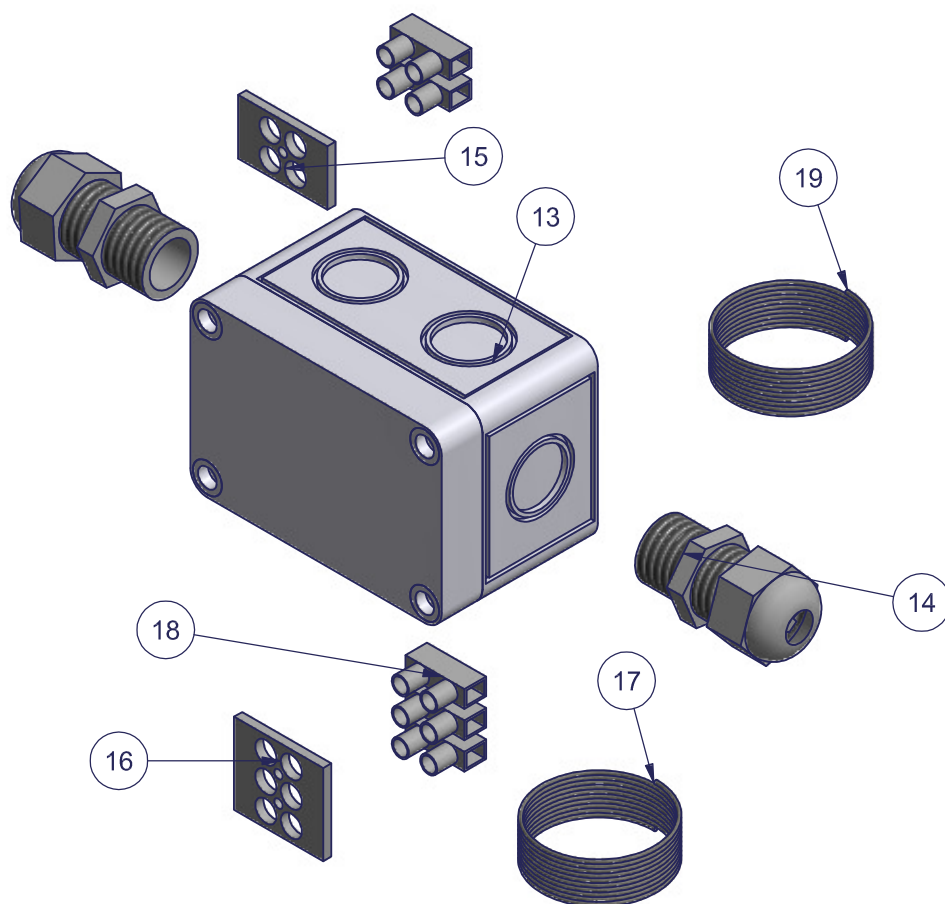

Parts List			
ITEM	QTY	PART NUMBER	DESCRIPTION
13	1	S13195	ELEC BOX, LIGHT GRAY, #125-402
14	2	S16250	CONNECTOR, CORD .236-.472, 1/2" NPT
15	1	S18668	TERMINAL STRIP MARKING PLATE, 4 HOLE
16	1	S18669	TERMINAL STRIP MARKING PLATE, 6 HOLE
17	1	S18190	HEATER WIRE FOR DOOR PANEL, ALUMINUM BRAIDED
18	2	S8455	TERMINAL STRIP #40.212
19	1	S18190.1	HEATER WIRE FOR FRAME, ALUMINUM BRAIDED

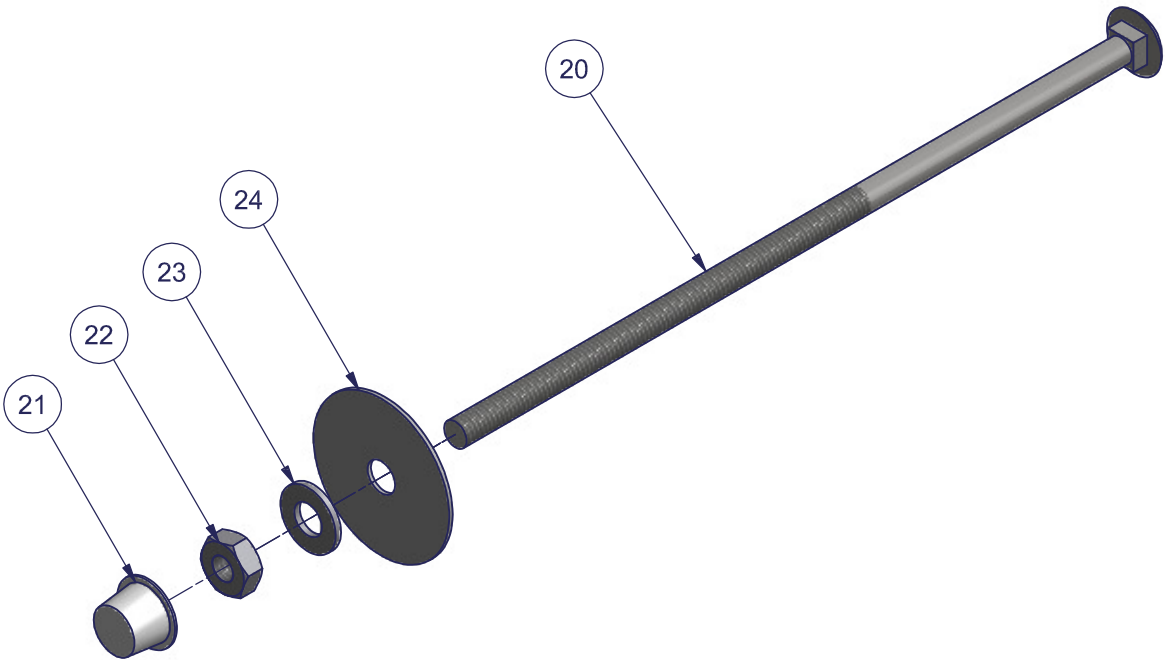

Parts List			
ITEM	QTY	PART NUMBER	DESCRIPTION
20	VARIES	S3540	BOLT, CARRIAGE 3/8-16 X 10, ZINC
21	VARIES	S18550	CAP, WHITE, PMI #19, HEX NUT CAP
22	VARIES	11337.00	NUT, HEX 3/8-16 ZINC PLATED
23	VARIES	12592.00	WASHER, FLAT USS 3/8 ZINC (7/16ID X 10D X 5/64 TH)
24	VARIES	S5785	WASHER, FENDER 3/8 X 2, ZINC
20 (Alt.)	VARIES	S18775	THREADED ROD, 3/8-16 X 18", ZINC

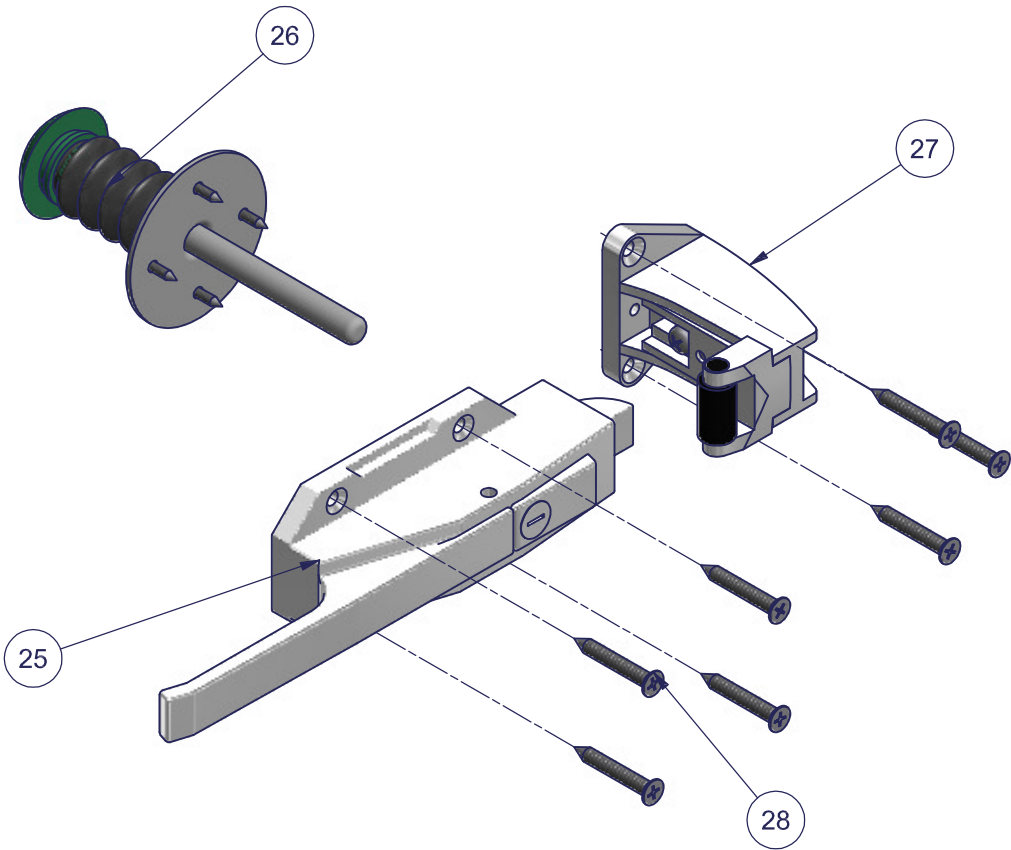

Parts List			
ITEM	QTY	PART NUMBER	DESCRIPTION
25	1	S7460C	LATCH SOFT TOUCH KIT WITH KEY, CHROME PLATED
26	1	S7460C.2	INSIDE RELEASE
27	1	S7460C.1	STRIKE
28	7	S18415	SCREW, FH SHT MTL #14 x 1-3/4, PHIL, S.S

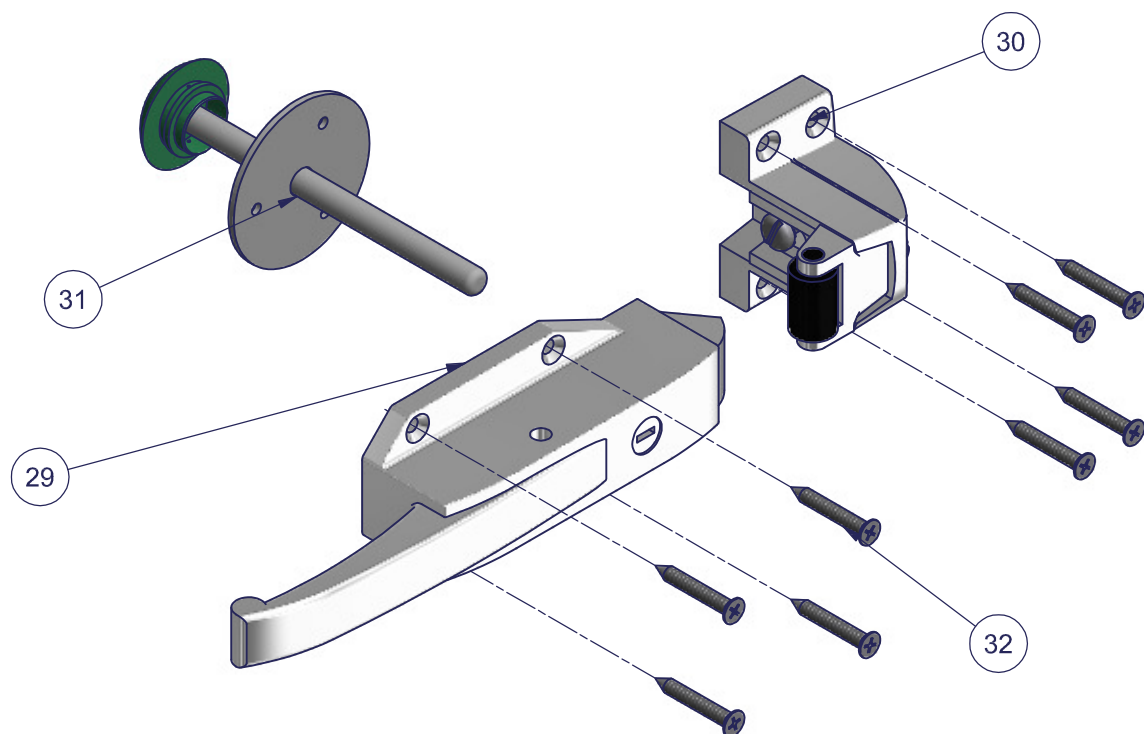

Parts List			
ITEM	QTY	PART NUMBER	DESCRIPTION
29	1	S7465	LATCH SOFT TOUCH W/KEY
30	1	S1825	STRIKE 3/4" x 1 1/2"
31	1	S5835	RELEASE, INSIDE RELEASE 4"
32	8	S18415	SCREW, FH SHT MTL #14 x 1-3/4, PHIL, S.S

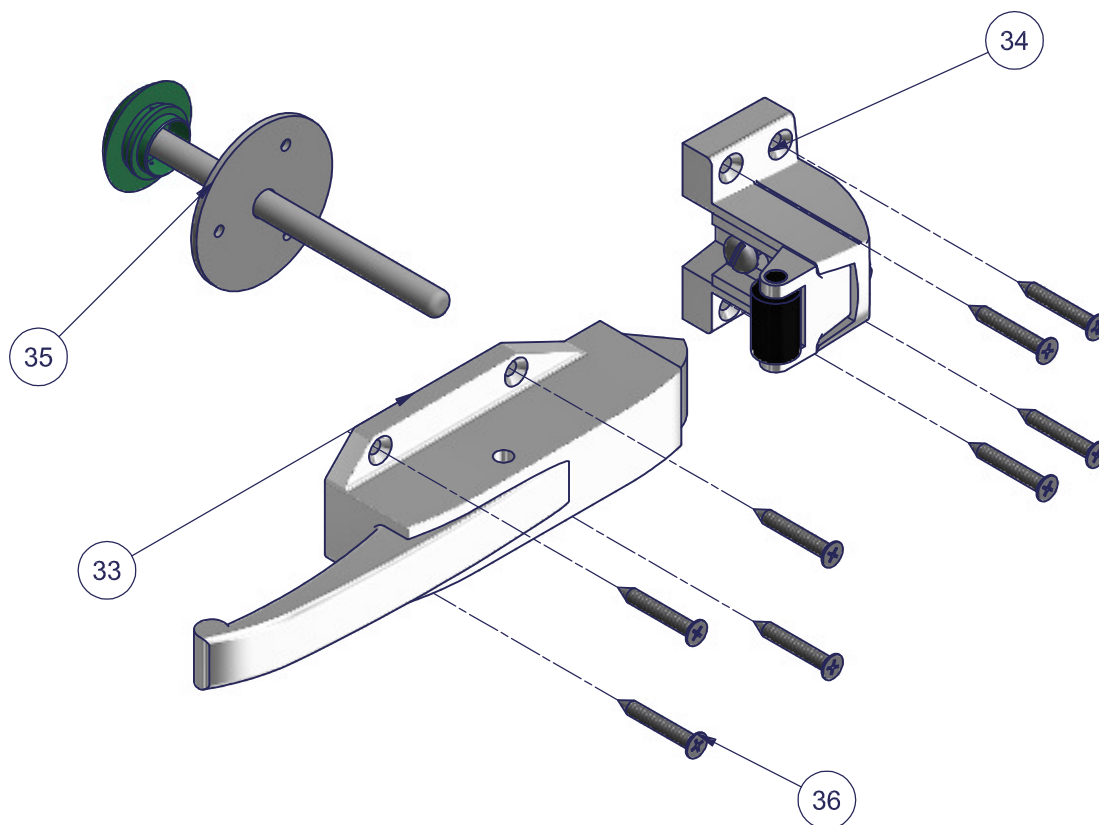

Parts List			
ITEM	QTY	PART NUMBER	DESCRIPTION
33	1	S7460	LATCH SOFT TOUCH
34	1	S1825	STRIKE 3/4" x 1 1/2"
35	1	S5835	RELEASE, INSIDE RELEASE 4"
36	8	S18415	SCREW, FH SHT MTL #14 x 1-3/4, PHIL, S.S

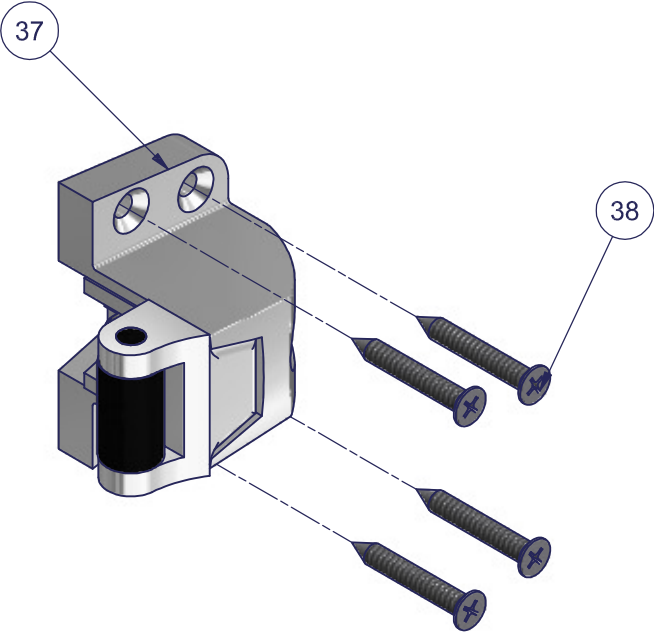

Parts List			
ITEM	QTY	PART NUMBER	DESCRIPTION
37	1	S1840	FLUSH STRIKE FOR MODEL DSW
38	4	S18415	SCREW, FH SHT MTL #14 x 1-3/4, PHIL, S.S

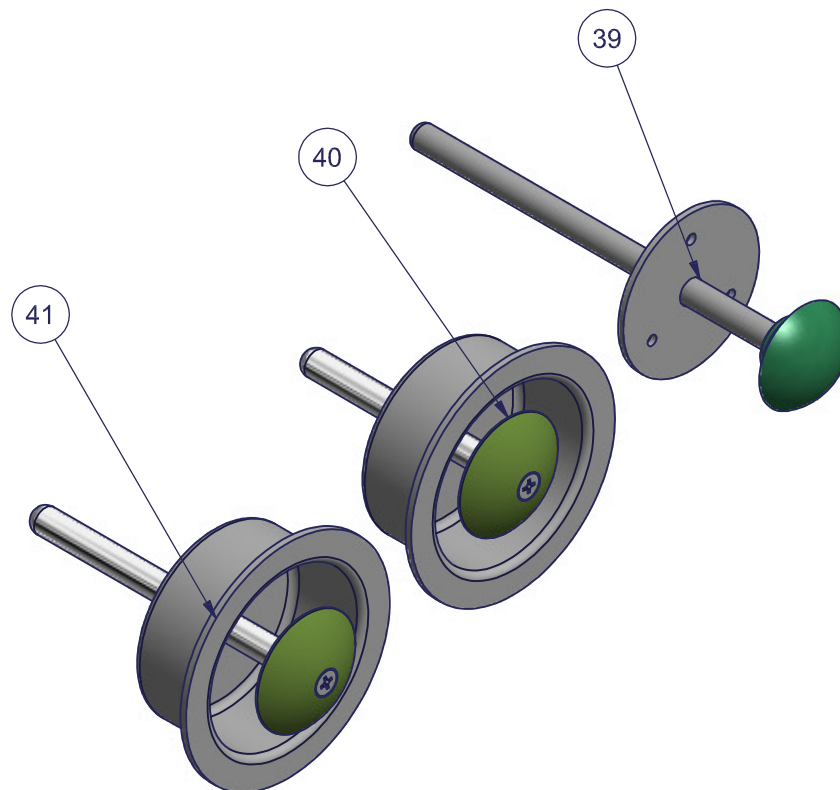

Parts List			
ITEM	QTY	PART NUMBER	DESCRIPTION
39	1	S4715	RELEASE, INSIDE RELEASE 6" METAL
40	1	S16645	RELEASE, INSIDE 4" METAL, RECESSED
41	1	S1830	RELEASE, INSIDE REALEASE RECESSED FOR 6" THICK DOOR

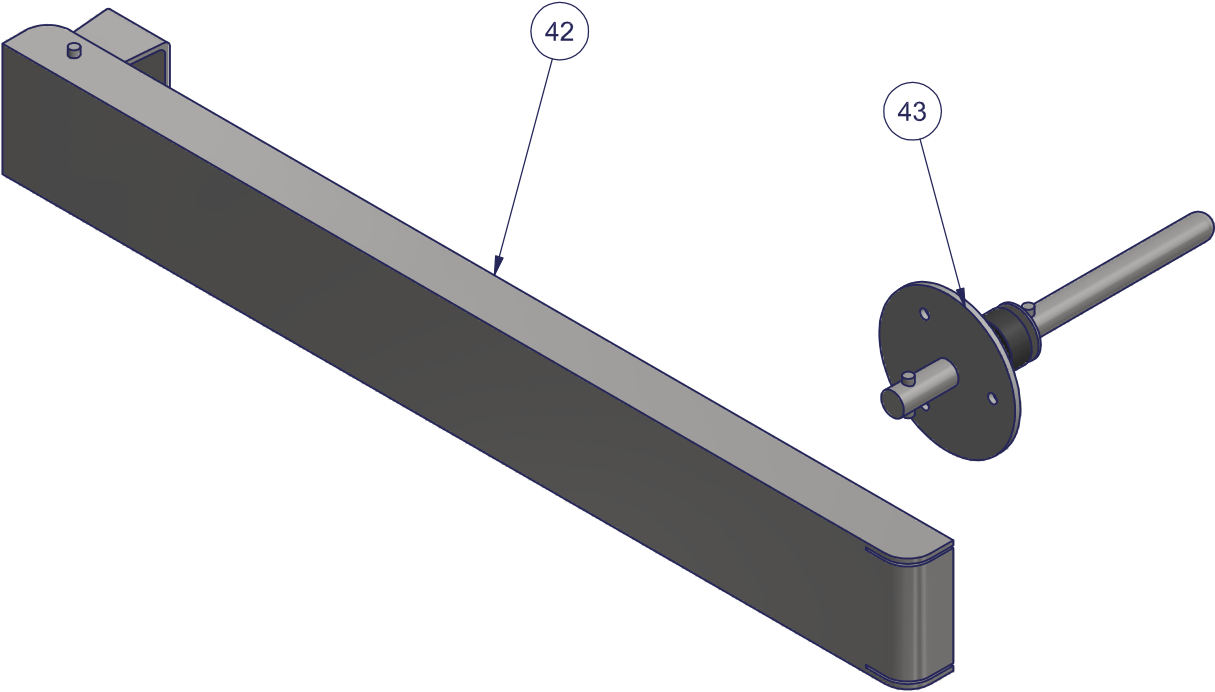

Parts List			
ITEM	QTY	PART NUMBER	DESCRIPTION
42	1	S18793	PANIC BAR, W28-Y631, USE WITH INSIDE RELEASE S18794.80
43	1	S18794.80	RELEASE, INSIDE RELEASE S/S, LESS BRASS KNOB W28-Y634, USE W/ PANIC BAR S18793

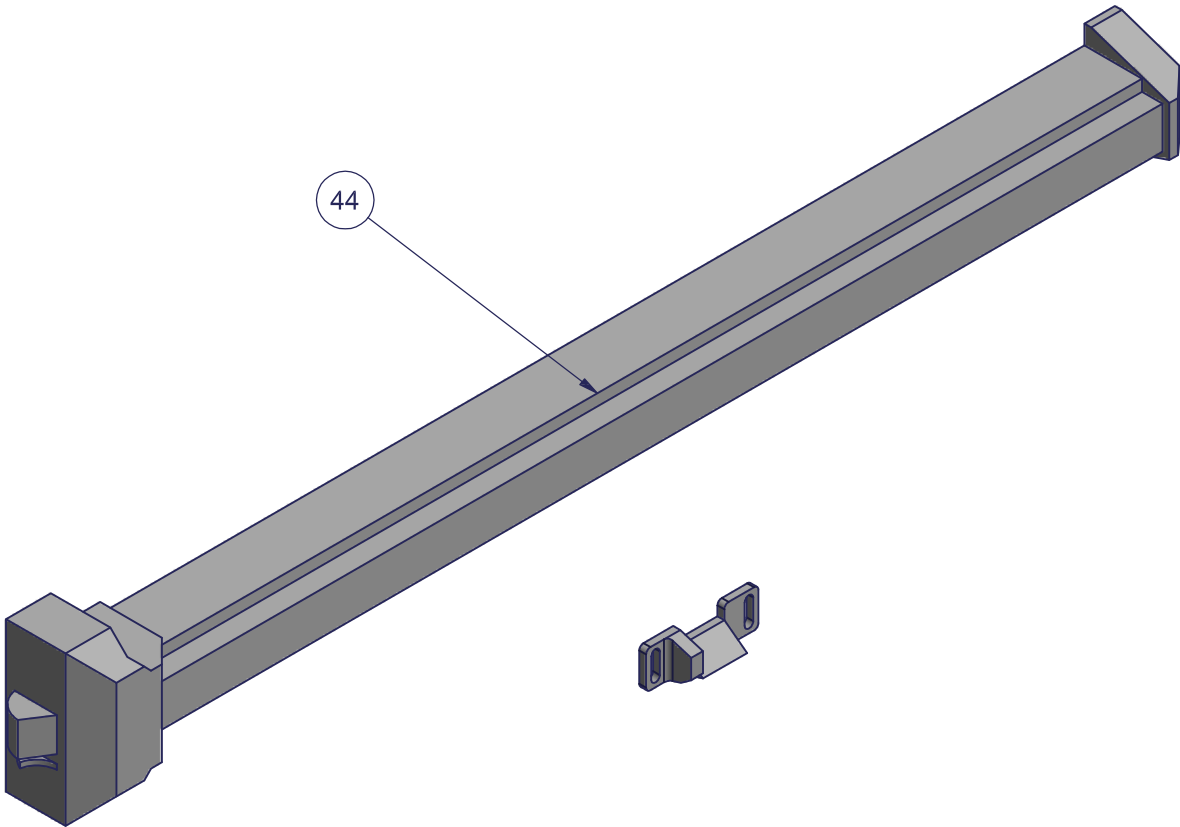

Parts List			
ITEM	QTY	PART NUMBER	DESCRIPTION
44	1	S5265	PANIC BAR, RIM TYPE EXIT DEVICE, REVERSIBLE #UL520AL

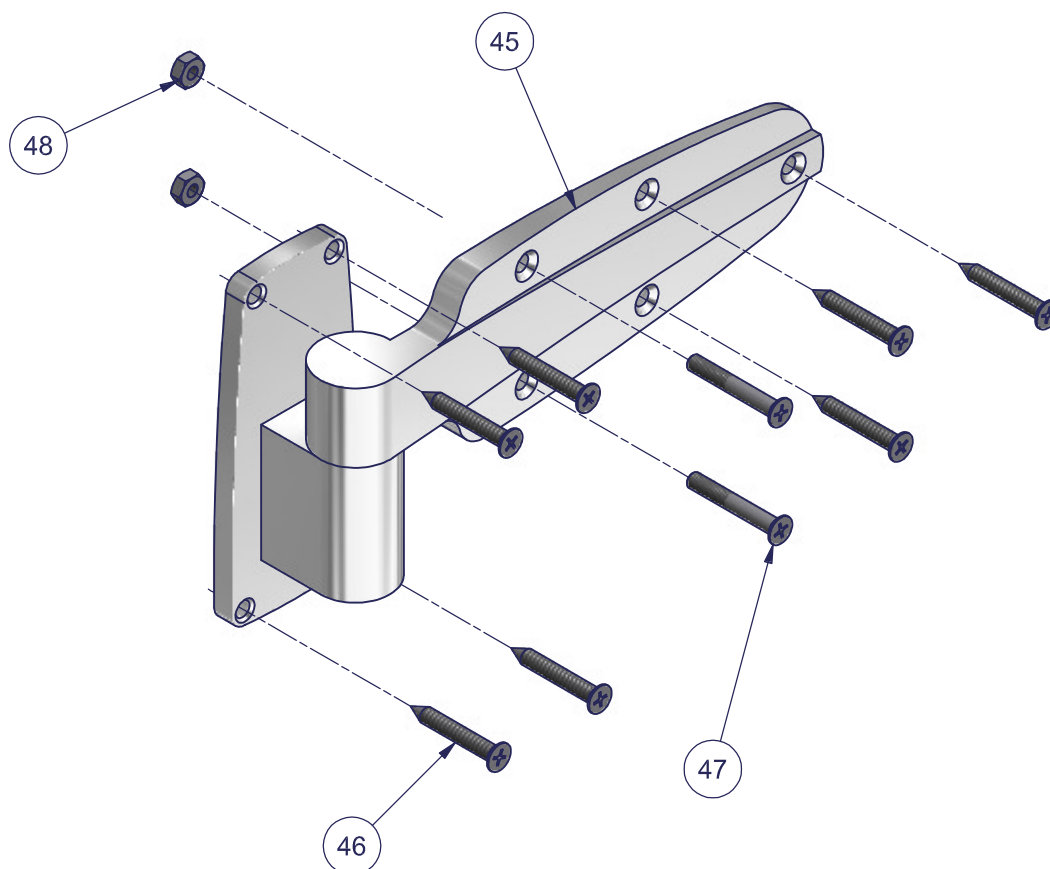

Parts List			
ITEM	QTY	PART NUMBER	DESCRIPTION
45	1	S18530C	HINGE 1 3/8" 1245, CHROME PLATED
46	7	S18415	SCREW, FH SHT MTL #14 x 1-3/4, PHIL, S.S
47	2	S18427	SCREW, FH MACHINE 1/4-20 X 1-3/4, PHIL S.S.
48	2	S18790	NUT, HEX NYLON STOP, 1/4-20 STAINLESS STEEL
46 (Alt.)	7	S18616	SCREW, FH SHT MTL #14 X 1 3/4 PHILLIPS PIN IN HEAD TAMPER RESISTANT
47 (Alt.)	2	S18617	SCREW, FH MACHINE 1/4-20 X 1 3/4 PHILLIPS PIN IN HEAD TAMPER RESISTANT
49	1	S18497	BIT, PHILLIPS PIN IN HEAD TAMPER PROOF SECURITY #14 SCREW, PART #2B.3 (REQUIRED FOR TAMPER RESISTANT SCREWS)

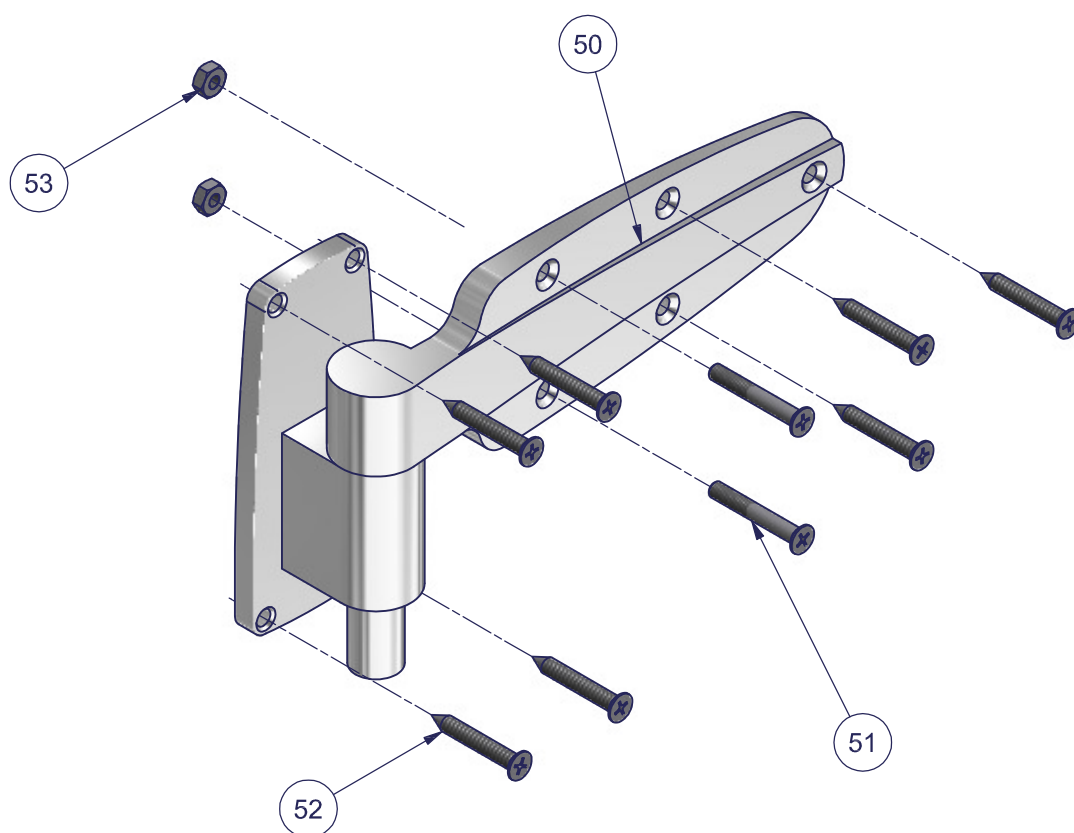

Parts List			
ITEM	QTY	PART NUMBER	DESCRIPTION
50	1	S18531C	HINGE-1 3/8 SPRING LOADED, CHROME PLATED
51	2	S18427	SCREW, FH MACHINE 1/4-20 X 1-3/4, PHIL S.S.
52	7	S18415	SCREW, FH SHT MTL #14 x 1-3/4, PHIL, S.S
53	2	S18790	NUT, HEX NYLON STOP, 1/4-20 STAINLESS STEEL
51 (Alt.)	2	S18617	SCREW, FH MACHINE 1/4-20 X 1 3/4 PHILLIPS PIN IN HEAD TAMPER RESISTANT
52 (Alt.)	7	S18616	SCREW, FH SHT MTL #14 X 1 3/4 PHILLIPS PIN IN HEAD TAMPER RESISTANT
54	1	S18497	BIT, PHILLIPS PIN IN HEAD TAMPER PROOF SECURITY #14 SCREW, PART #2B.3 (REQUIRED FOR TAMPER RESISTANT SCREWS)

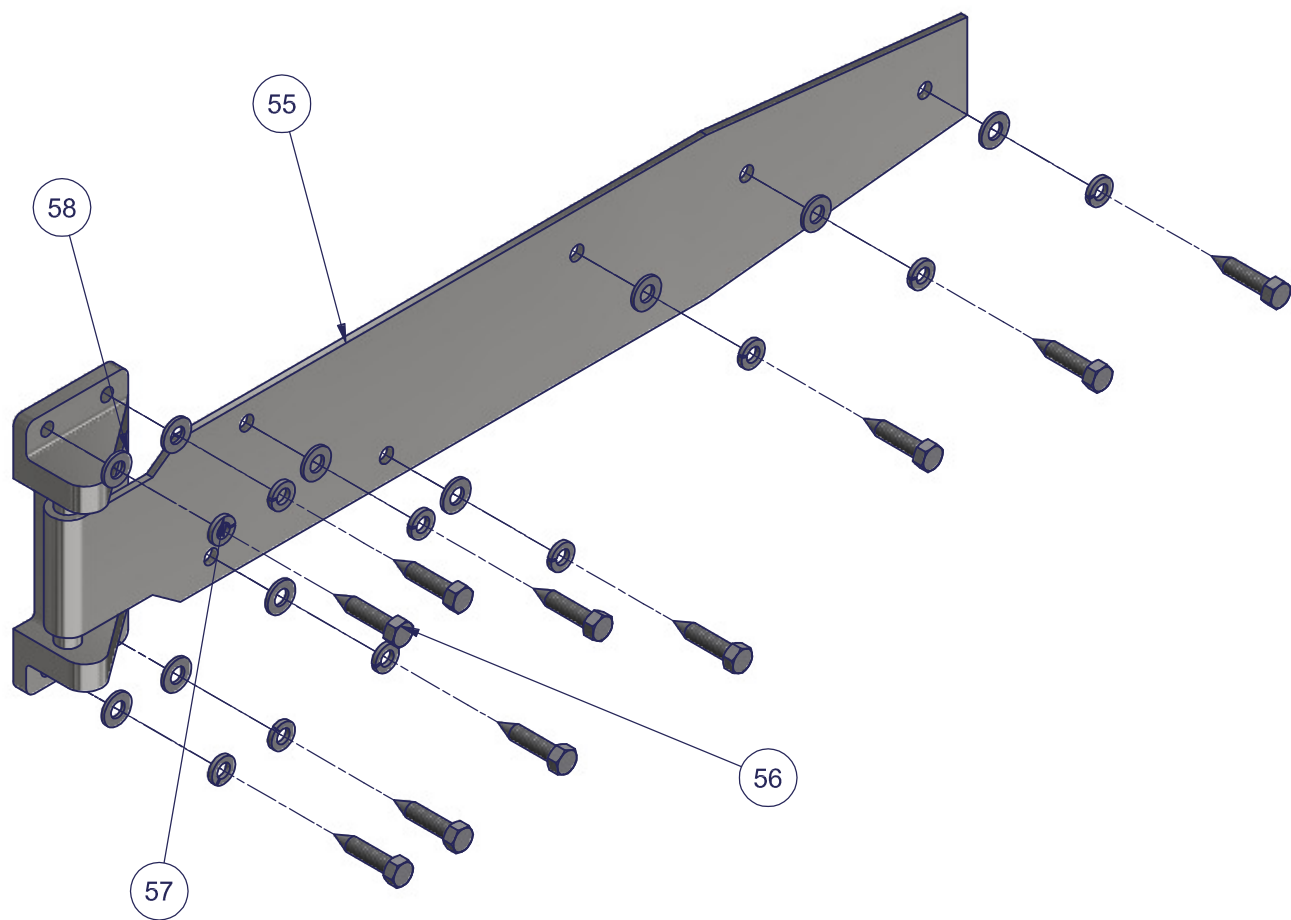

Parts List			
ITEM	QTY	PART NUMBER	DESCRIPTION
55	1	S18685	HINGE, STRAP, 1 3/8" OFFSET, CAM LIFT, REVERSIBLE
56	10	S18417	BOLT, HEX LAG 3/8 X 1-3/4, S.S.
57	10	17558.00	WASHER, SPLIT LOCK 3/8 S.S.
58	10	22808.00	WASHER, FLAT 3/8 SS 37RWF1 STAINLESS STEEL

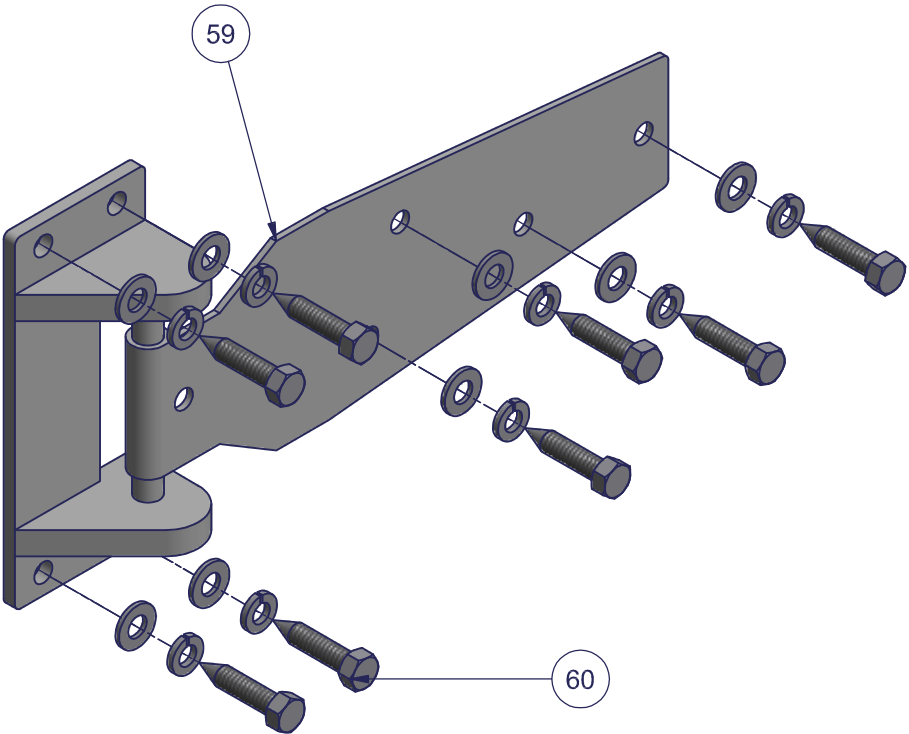

Parts List			
ITEM	QTY	PART NUMBER	DESCRIPTION
59	1	S18684	HINGE, STAINLESS STEEL, 1 3/8" OFFSET
60	8	S18417	BOLT, HEX LAG 3/8 X 1-3/4, S.S.
61	8	17558.00	WASHER, SPLIT LOCK 3/8 S.S.
62	8	22808.00	WASHER, FLAT 3/8 SS 37RWAF1 STAINLESS STEEL

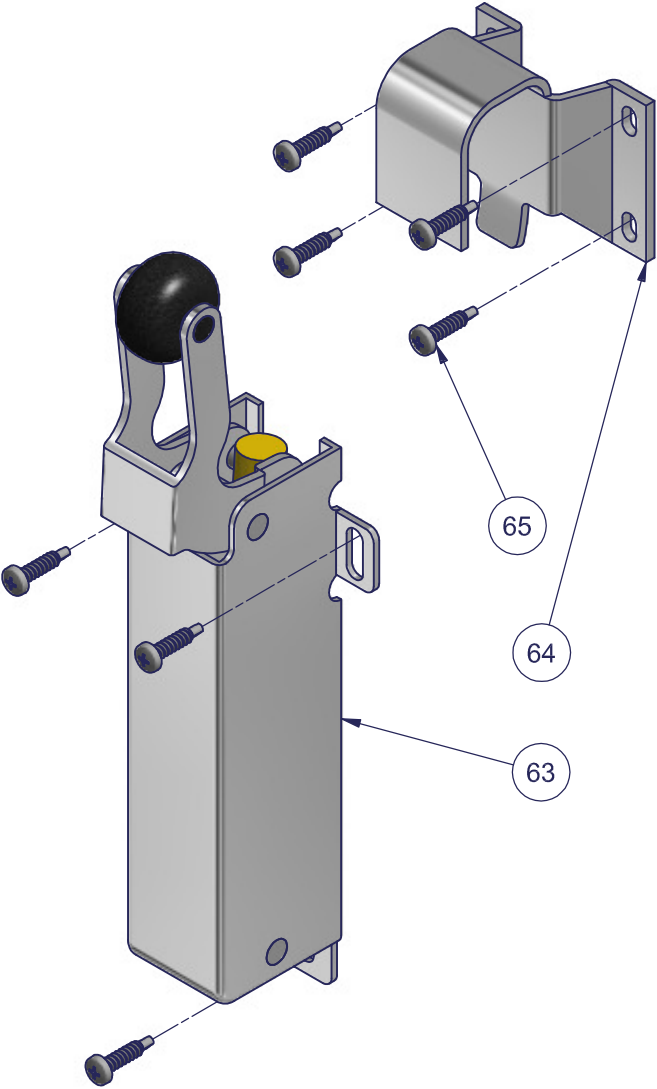

Parts List			
ITEM	QTY	PART NUMBER	DESCRIPTION
63	1	S1490C	DOOR CLOSER-1094 KASON# 1094000003
64	1	S11030	CLOSER, DOOR CLOSER HOOKS 1094
65	7	S18406	SCREW, TEK PH, #8 X 3/4, PHIL S.S.

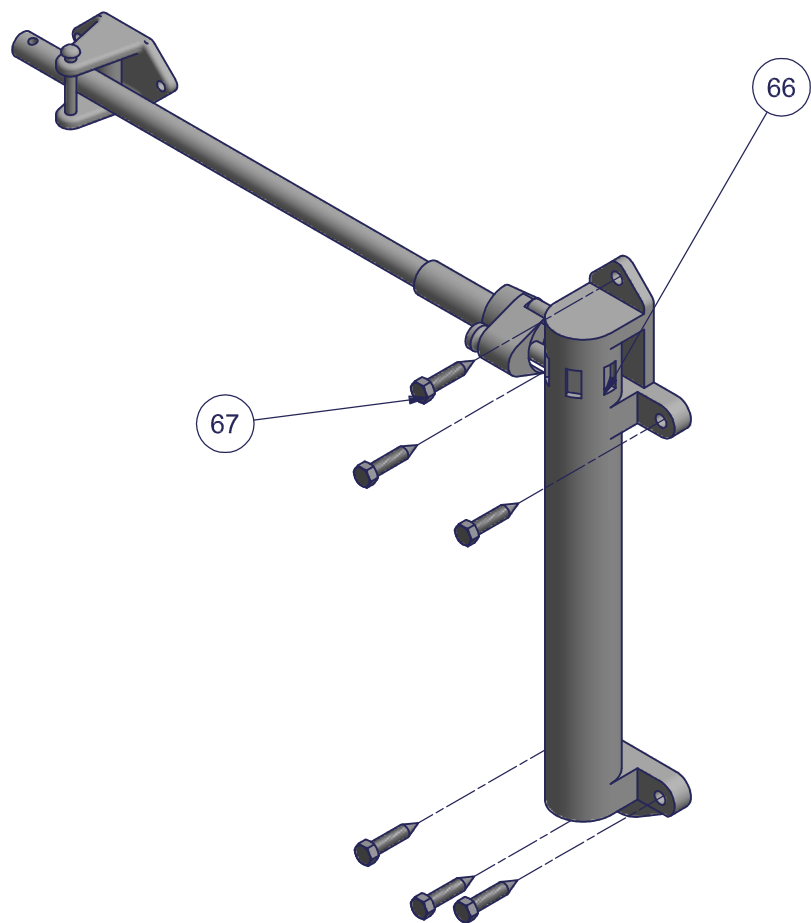

Parts List			
ITEM	QTY	PART NUMBER	DESCRIPTION
66	1	S4300	DOOR CLOSER - HEAVY DUTY, KASON 1097-4 (1097000004)
67	6	S18417	BOLT, HEX LAG 3/8 X 1-3/4, S.S.

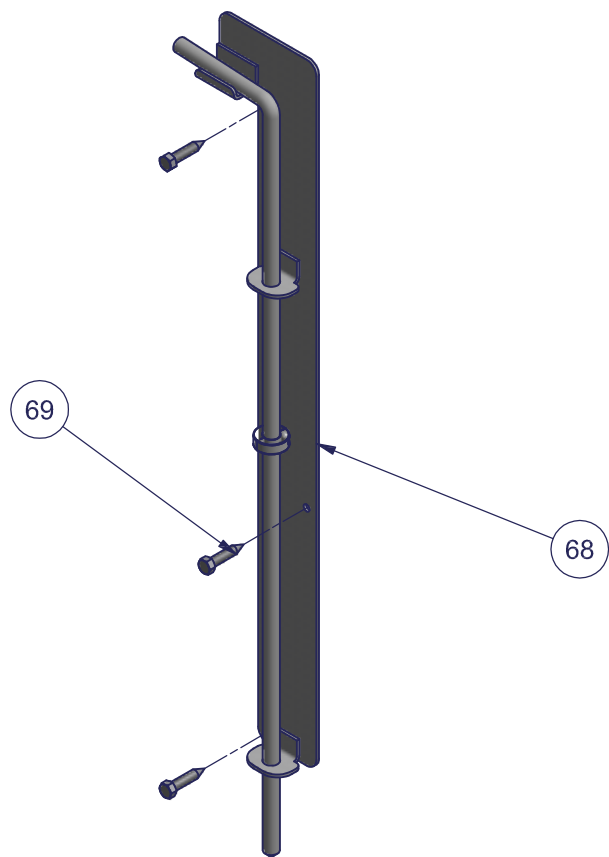

Parts List			
ITEM	QTY	PART NUMBER	DESCRIPTION
68	1	13372.00	CANE BOLT, 36", LH
69	3	S18417	BOLT, HEX LAG 3/8 X 1-3/4, S.S.

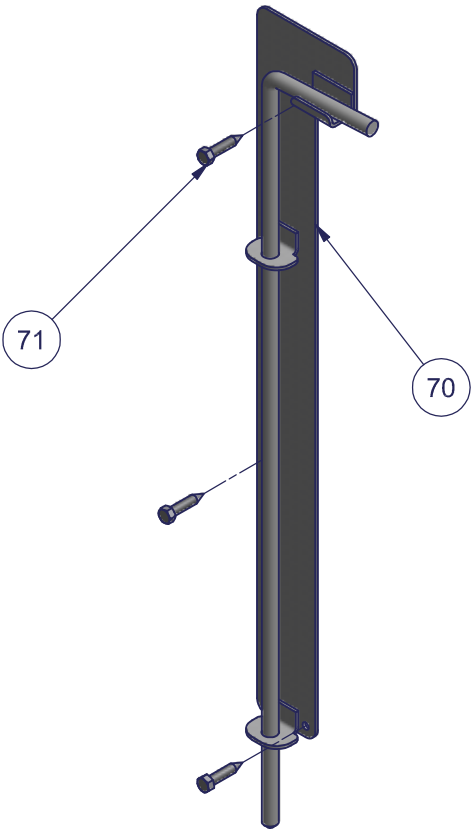

Parts List			
ITEM	QTY	PART NUMBER	DESCRIPTION
70	1	13371.00	CANE BOLT, 36", RH
71	3	S18417	BOLT, HEX LAG 3/8 X 1-3/4, S.S.

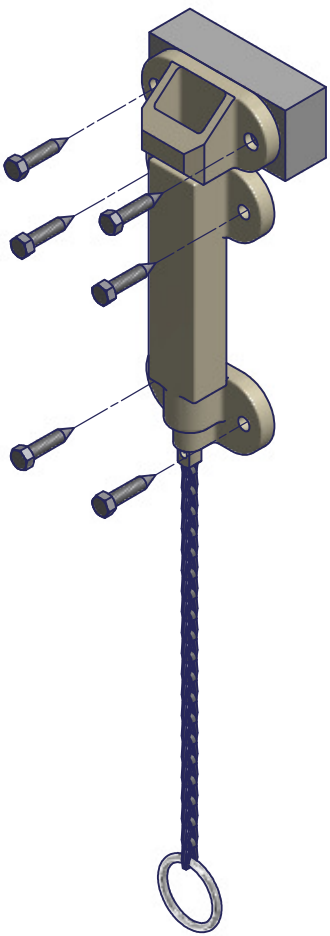

Parts List			
ITEM	QTY	PART NUMBER	DESCRIPTION
72	1	S18350	SPRING BOLT LATCH
73	6	S18417	BOLT, HEX LAG 3/8 X 1-3/4, S.S.
74	1	S18602	SPACER FOR SPRING BOLT STRIKE

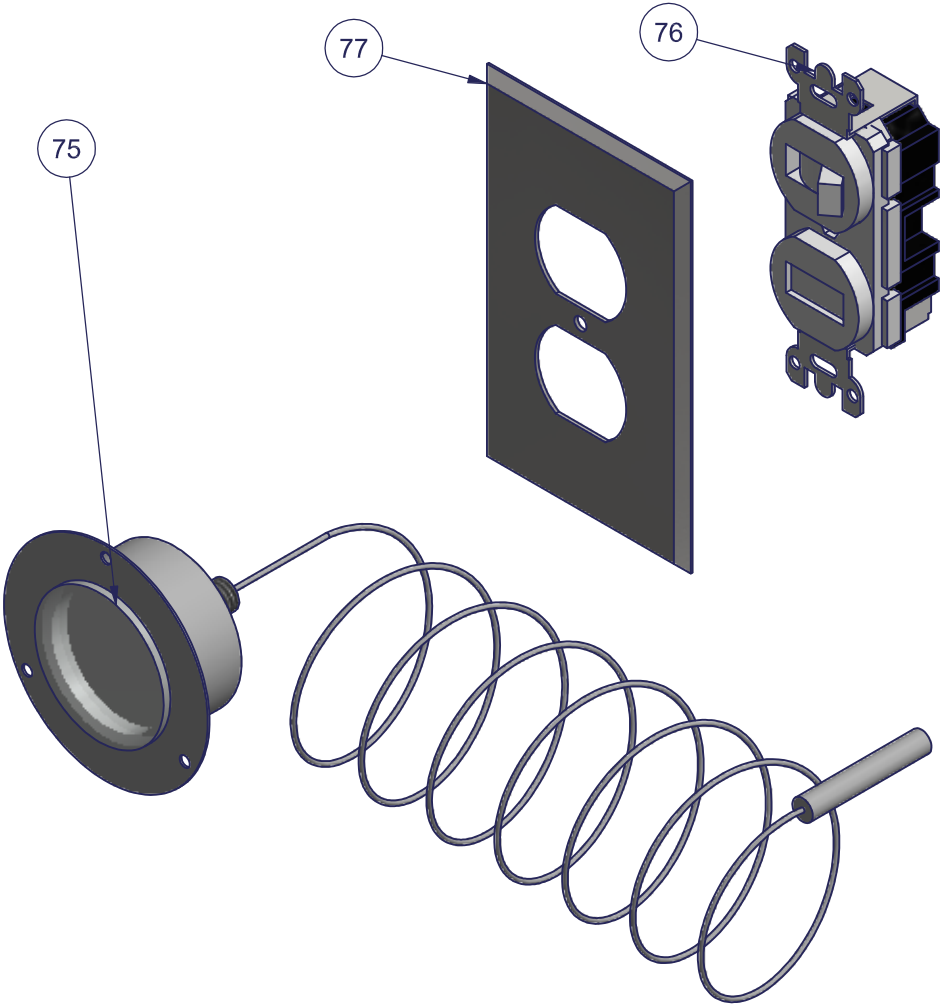

Parts List			
ITEM	QTY	PART NUMBER	DESCRIPTION
75	1	S1885	THERMOMETER, -40°F TO 65°F, #16-020, 2" DIAL, 48" LEAD
76	1	S12005	SWITCH, LIGHT WHITE #5226-W
77	1	S13090	LIGHT SWITCH COVER PLATE PART# 84003

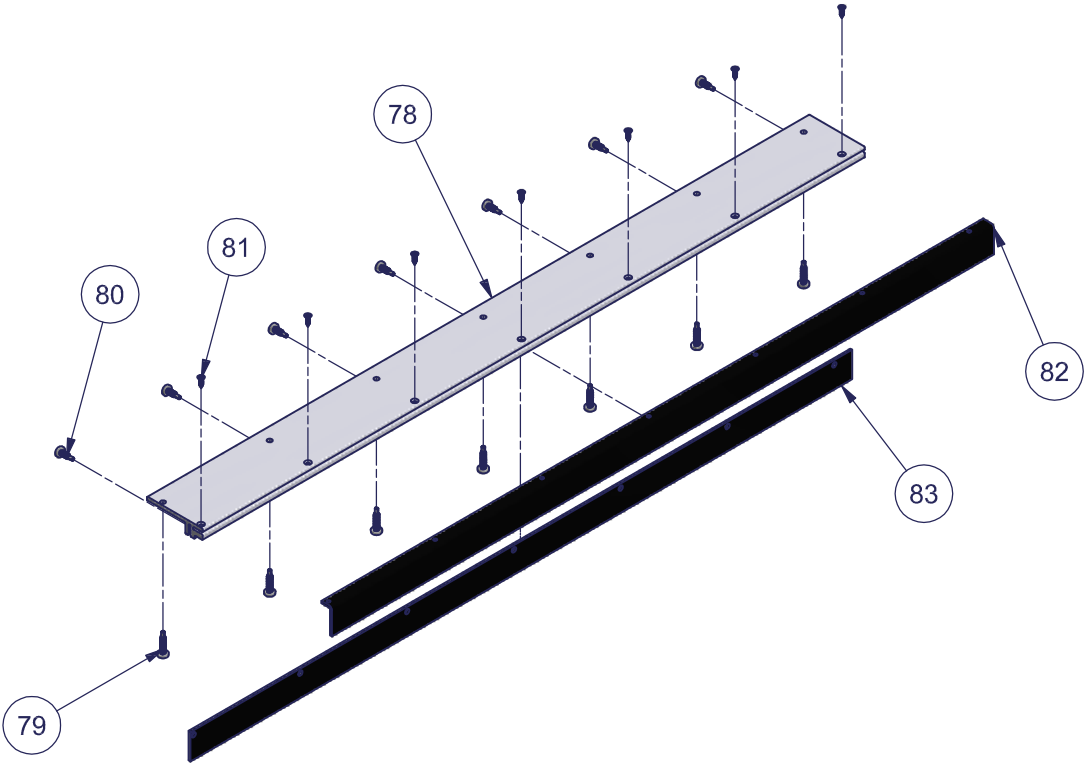

Parts List			
ITEM	QTY	PART NUMBER	DESCRIPTION
78	1	S8515	SWEEP RETAINER, ITEM #8
79	VARIES	S18406	SCREW, TEK PH, #8 X 3/4, PHIL S.S.
80	VARIES	S18407	SCREW, TEK PH, #8 X 1/2, PHIL S.S.
81	VARIES	S18408	SCREW, FH SHT MTL #4 x 3/8, PHIL S.S
82	1	S14280	RUBBER 1/16" X 2-7/8" X 50' BLACK NEOPRENE C/ I
83	1	S15350	RUBBER, 1/16" X 2-1/2" BLACK

PLEASE PROVIDE SERIAL NUMBER: _____

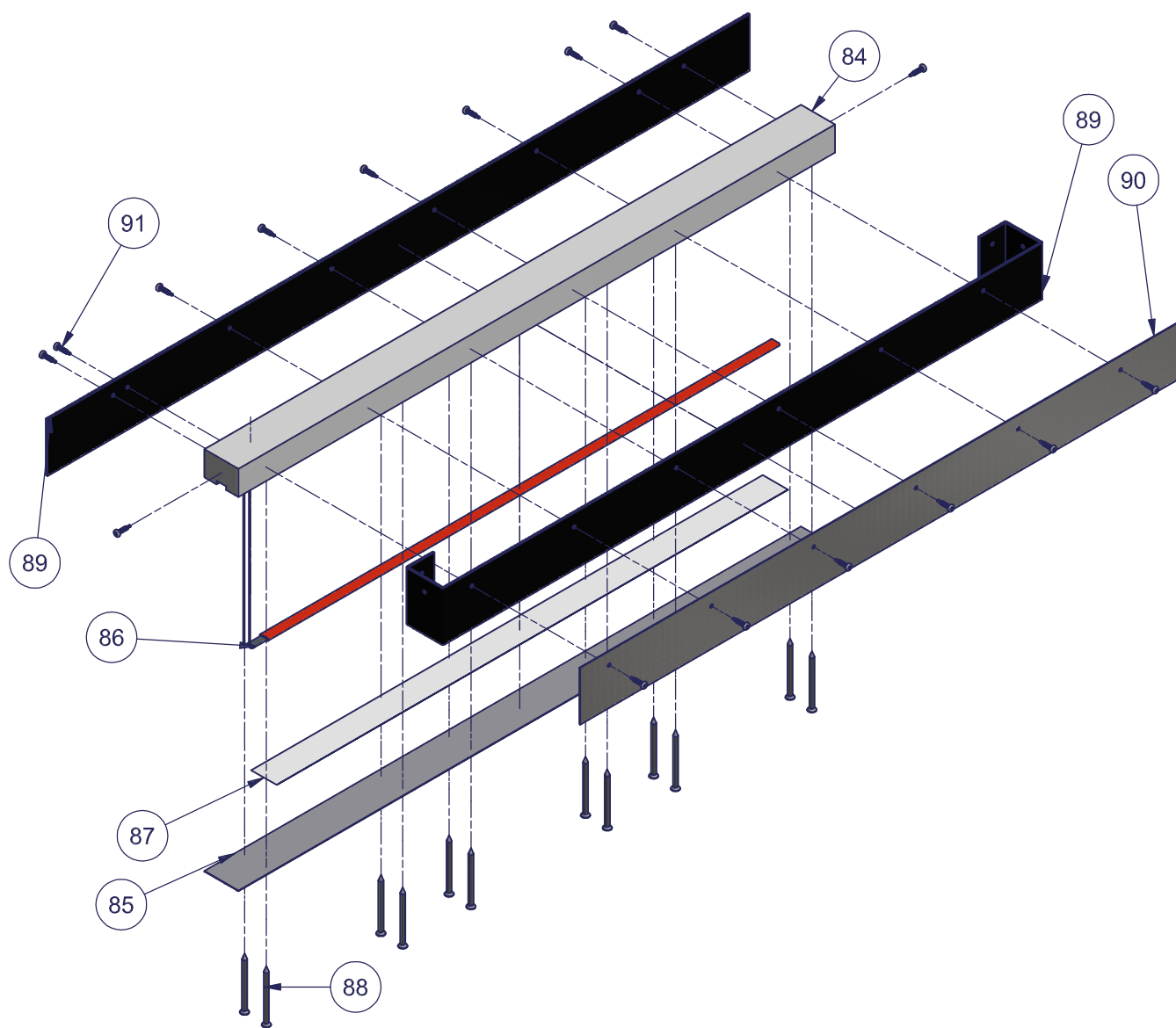

FOR PARTS LIST,
SEE FOLLOWING PAGE.

ColdGuard SSW

Parts List			
ITEM	QTY	PART NUMBER	DESCRIPTION
84	1	S18484	RETAINER, BOTTOM BAR HEATER
85	1	S18080	BOTTOM BAR HEATER SHEET METAL COVER
86	1	S18687	HEATER WIRE, CHROMALOX, 16"
86 (Alt.1)	1	S18686	HEATER WIRE, CHROMALOX, 18"
86 (Alt.2)	1	S18572	HEATER WIRE, CHROMALOX, 24"
86 (Alt.3)	1	S16500	HEATER WIRE, CHROMALOX, 30"
86 (Alt.4)	1	S4565	HEATER WIRE, CHROMALOX, 36"
86 (Alt.5)	1	S17260	HEATER WIRE, CHROMALOX, 42"
86 (Alt.6)	1	S6300	HEATER WIRE, CHROMALOX, 48"
86 (Alt.7)	1	S6305	HEATER WIRE, CHROMALOX, 54"
86 (Alt.8)	1	S18075	HEATER WIRE, CHROMALOX, 60"
86 (Alt.9)	1	S16620	HEATER WIRE, CHROMALOX, 66"
86 (Alt.10)	1	S18688	HEATER WIRE, CHROMALOX, 72"
86 (Alt.11)	1	S18689	HEATER WIRE, CHROMALOX, 78"
86 (Alt.12)	1	S18690	HEATER WIRE, CHROMALOX, 84"
87	1	S18499	TAPE, ALUMINUM FOIL TAPE, #5503 - 3" X 50 YARDS PER ROLL
88	12	S18414	SCREW, FH SHT MTL #12 x 3, PHIL STAINLESS
89	2	S15350	RUBBER, 1/16" X 2-1/2" BLACK
90	1	S5585	SHEET, ALUM DIAMND PLT .063, 3003 TREAD BRITE
91	16	S18406	SCREW, TEK PH, #8 X 3/4, PHIL S.S.

PLEASE PROVIDE SERIAL NUMBER:_____

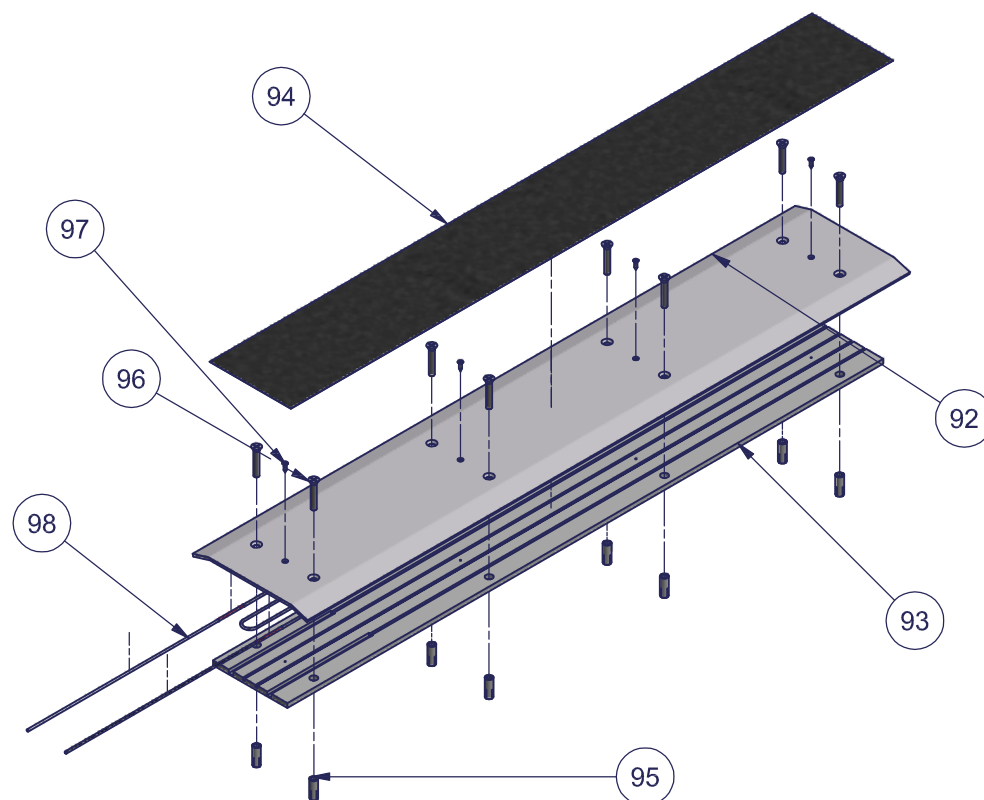

Parts List			
ITEM	QTY	PART NUMBER	DESCRIPTION
92	1		THRESHOLD, SEE INFORMATION REQUIRED BELOW
93	1		UNDERLAYMENT WITH HEATER WIRE
94	1	S18478	TREAD, SLIP RESISTANT, 6" x 60 FT ROLL 3M # 610-BLK # 6970
95	8	20178.00	ANCHOR, DROP IN 1/4-20 1" LG. ZINC
96	8	21973.00	SCREW, FH MACHINE 1/4-20X1-1/2 PHILLIPS, S.S. 25C150MPF
97	4	S18459	SCREW, FH SHT MTL #6 x 1/2, PHIL, S.S
98	1		HEATER WIRE

PLEASE SELECT THE FOLLOWING:

THRESHOLD WIDTH THRESHOLD MATERIAL

☐ 6 3/4"

☐ ALUMINUM

☐ 9"

☐ STAINLESS STEEL

PLEASE INDICATE THRESHOLD LENGTH: _____

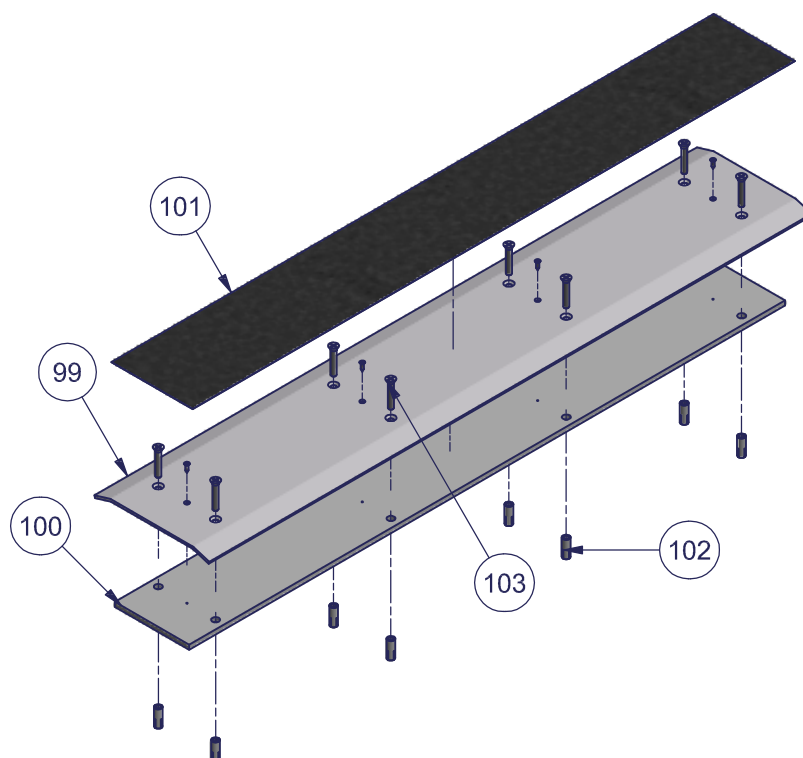

Parts List			
ITEM	QTY	PART NUMBER	DESCRIPTION
99	1		THRESHOLD, SEE INFORMATION REQUIRED BELOW
100	1		UNDERLAYMENT, NO HEATER WIRE
101	1	S18478	TREAD, SLIP RESISTANT, 6" x 60 FT ROLL 3M # 610-BLK # 6970
102	8	20178.00	ANCHOR, DROP IN 1/4-20 1" LG. ZINC
103	8	21973.00	SCREW, FH MACHINE 1/4-20X1-1/2 PHILLIPS, S.S. 25C150MPF
104	4	S18459	SCREW, FH SHT MTL #6 x 1/2, PHIL, S.S

PLEASE SELECT THE FOLLOWING:

THRESHOLD WIDTH THRESHOLD MATERIAL

☐ 6 3/4"

☐ ALUMINUM

☐ 9"

☐ STAINLESS STEEL

PLEASE INDICATE THRESHOLD LENGTH: _____

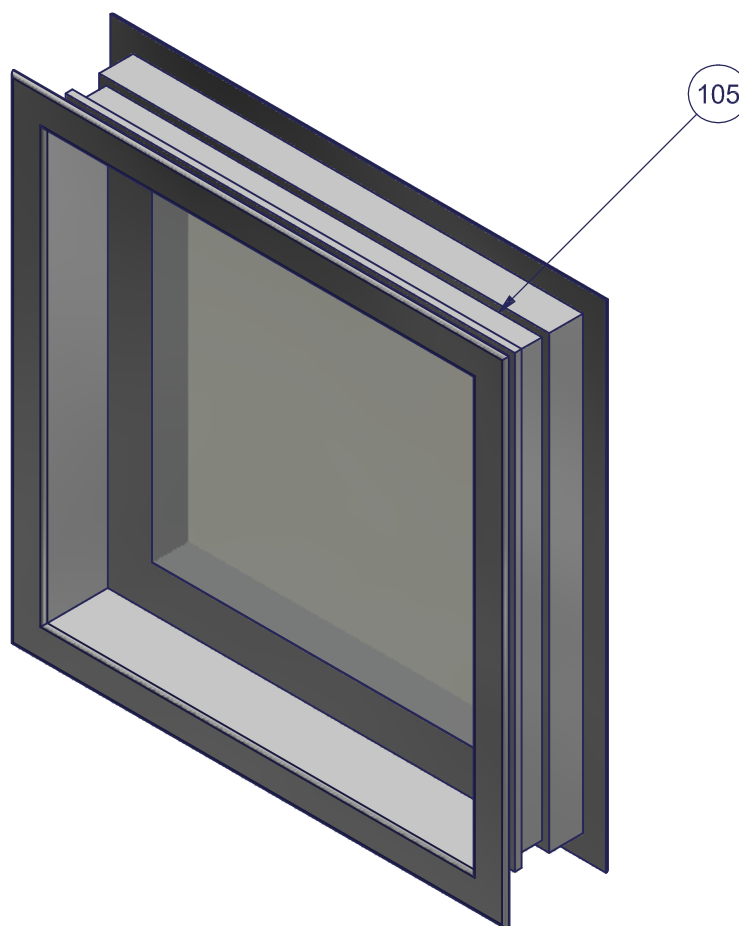

Parts List

ITEM	QTY	PART NUMBER	DESCRIPTION
105	1	S4290	WINDOW, NON-HEATED 14x14, 55084-4, (4 INCH THICK DOOR)
106	1	S5315	WINDOW, NON-HEATED 14x24, 55084-9, (4 INCH THICK DOOR)
107	1	S4285	WINDOW, HEATED 14x14, 55082-4A, (4 INCH THICK DOOR)
108	1	S5320	WINDOW, HEATED 14x24, 55082-9A, (4 INCH THICK DOOR)
109	1	S18662	WINDOW, NON-HEATED 14x14x6, 55084-12, (6 INCH THICK DOOR)
110	1	S18664	WINDOW, NON-HEATED 14x24x6, 55084-11, (6 INCH THICK DOOR)
111	1	S18663	WINDOW, HEATED 14x14x6, 55082-12A, (6 INCH THICK DOOR)
112	1	S18665	WINDOW, HEATED 14x24x6, 55082-11A, (6 INCH THICK DOOR)