

AVIATION



H-SERIES

BOTTOM ROLLING



DOOR
ENGINEERING

— A SENNECA COMPANY —

DoorEngineering.com

800.959.1352





H-SERIES BOTTOM ROLLING

Bottom rolling hangar door systems are precisely manufactured to accommodate openings of any size, making them a versatile and practical choice for various hangar facilities. Engineered to withstand substantial wind loads and harsh weather conditions, the bottom rolling hangar door system is a reliable solution for ensuring the security and protection of valuable assets housed within the hangar.

With a range of configuration options such as “Smart Rail”, Bi-Parting, Uni-Directional, and Independent, these doors can be tailored to suit the specific requirements of different hangar facilities, from fixed base operation facilities to government installations. The flexibility and durability of the bottom rolling hangar doors make them an ideal choice for those seeking a dependable hangar door solution.



DESIGN PARTNER

You're not just getting a bid; you're getting a Partner. Our Technical Sales and Engineering teams consult with you during the design phase of your project to make sure you have accurate coordination drawings and engineered loading details specific to your building.



Consult with our Technical Sales and Engineering team to determine which door configuration best meets your access needs.

DoorEngineering.com
800.959.1352



CONFIGURATIONS

“SmartRail”

- Offers maximum flexibility of entire opening.
- 3-Way Stacking: Bi-part, All left, or All right.
- No dedicated stacking space or pockets required.

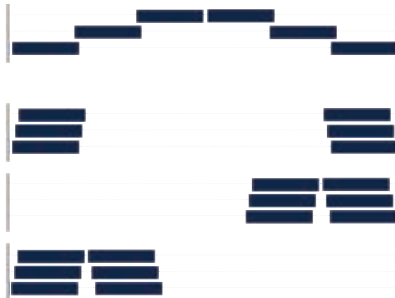

Bi-Parting

- Stacking space (pockets) on both sides of opening.
- Ability to open one half of the opening.
- Operators in the center door sections.



Uni-Directional

- Stacking space (pocket) on one side only.
- Requires only a single operator.

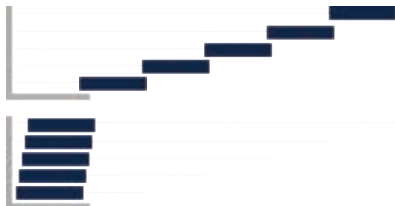

Custom Options

- Designed to meet your specific access needs.
- Personnel Doors, Vehicle Doors, Tail Doors, and Apertures.



FEATURES

The Door Engineering Advantage

Door Engineering is the market leader in manufacturing bottom rolling hangar door systems. Our systems are engineered and delivered to the job site in modular assemblies designed to **ensure accuracy and reduce installation time by up to 50%**. The following features ensure your door system is precise and on-time.

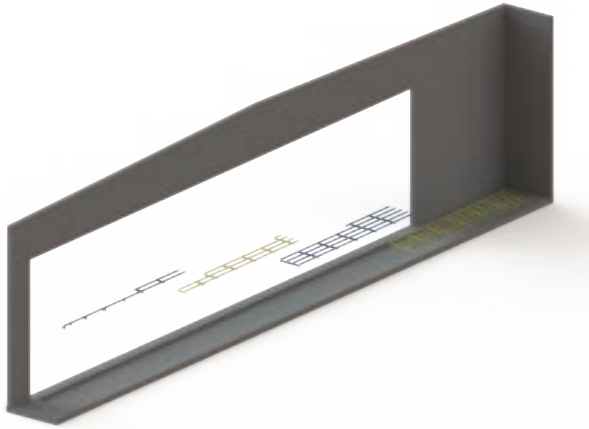

QuickSet Bottom Rails

- Our bottom rail assemblies are **FACTORY FABRICATED USING A JIG TABLE** in up to 29'-10" sub-sections with no need for pre-cast threaded rod.
- Includes leveling angle clips attached to the crossties and wedge anchor bolts to secure into the first pour of concrete.
- Factory fabricated sections provide superior quality, ensure accurate alignment, and **reduce field labor by up to 60%**.

Rail Forms

- Bottom rail forms are included to ensure a smooth flat surface between each rail and provide the proper clearance around the rail head.
- Factory furnished forms **reduce field labor by up to 50%** during the finish pour of concrete.

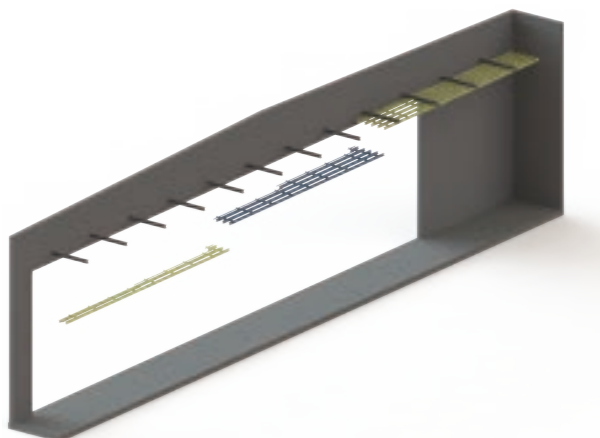

QuickLift Top Guides

- The top track assemblies are also **FACTORY FABRICATED USING A JIG TABLE** in up to 39'-10" sub-sections, welded and prime painted.
- Factory fabricated sub-sections **reduce labor by up to 50%** and provide superior quality and accurate alignment in the field.

DOOR ENGINEERING ADVANTAGE

Ensure accuracy
and reduce
installation
time by up to

50%

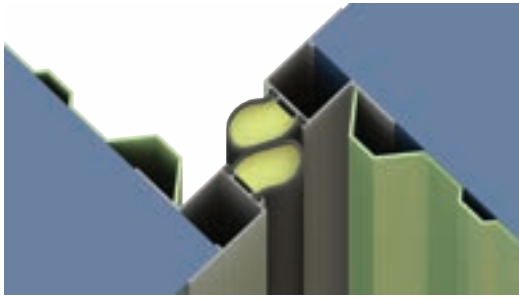

Weatherseals

- **WEATHERSEALS ATTACHED AT THE FACTORY! 100% Labor Savings** versus field installed weatherseal systems.
- Vertical weatherseals are a bulb type sheet rubber with a resilient urethane foam core creating the best sealing door on the market. Head and sill weatherseals are cloth inserted flap type sheet rubber (flexible, yet sturdy) and provide a weathertight seal.

Quick Disconnect Manual Operation

- The Aviation Hangar industry's most efficient manual disconnect.
- Our horizontal pivot operator allows fast and simple manual operation in the event of an electrical power failure, keeping you and your assets safe and on the move.

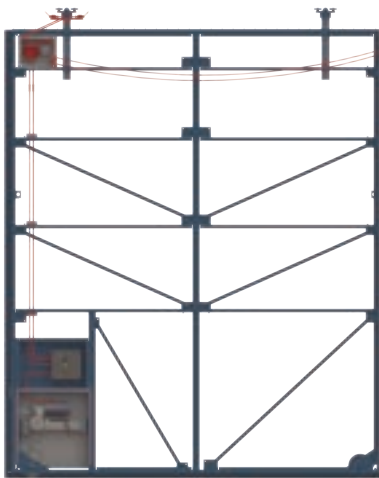

QuickConnect Electrical

- We include all conduit, fittings, wire raceways, and power cords from the factory, increasing quality and **reducing onsite electrical labor and material by up to 75%.**

Factory Installed Wheels and Housings

- Expect **100% time savings** versus field installed wheels and housings.

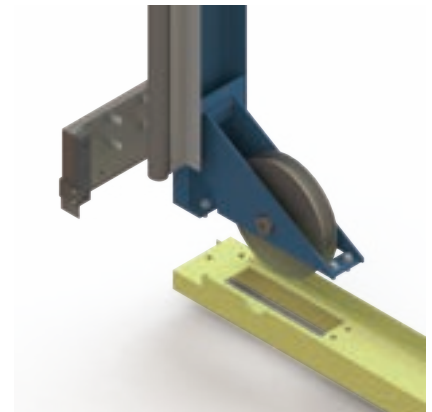

CUSTOM OPTIONS AND ACCESSORIES

Windows, vehicle access, personnel doors, aperture closures, safety and warning devices



RETROFIT/REFURBISH EXPERTS

Our knowledgeable Technical Sales and Engineering Teams will provide you with a solution for even the most challenging retrofit and refurbishment opportunities. Contact us today to arrange a site visit.

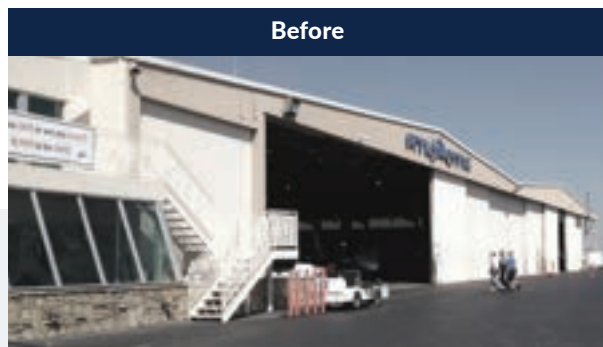

Door Engineering is the expert and your perfect resource for hangar rehabilitation and/or replacement.

Every hangar door refurbishment and/or replacement has its own unique needs. Our years of expertise can give the client the perfect door solution by keeping the original historic design, or modernizing it for today's fresh, new look! Either scenario will meet the current building codes and will provide years of trouble-free service. Door Engineering will consult with the customer, conduct onsite inspections, and provide design details and specifications that will ensure the customer's needs are met.

We offer a full range of replacement components for a refurbishment project including, but not limited to:

- Weatherseals
- Bottom rails
- Wheels and housings
- Top tracks
- Top roller assemblies
- Bumper assemblies
- Electrical feed rail system
- Draped S/O power cord
- Drop-In operator assemblies
- Door driver operator assemblies
- Electrical components

WHAT THE DOOR ENGINEERING ADVANTAGE MEANS FOR YOU:

Architects and Engineering

As a partner, we work with you to understand your customer's business and ensure that access to their hangar meets their needs both now and into the future. We are your design partner, helping coordinate all the interfaces and loading between the door and building.



Building Supplier

We can coordinate directly with the building manufacturer to provide interface details and loading information to meet specified requirements.



Contractor or Installer

Our premium features save up to 50% in install time, keeping your project ahead of schedule and reducing on-site disruptions. The Door Engineering solution provides a clear interface with a quick and accurate installation.



End-User

Door Engineering will provide the best solution to fit your needs now and into the future. Our weather seal system is the best in the industry and our low maintenance components will provide decades of service and protection for your valuable assets.



Call us for our expertise on: Hangar Solutions Consultation, Retro-Fit Inspections, Interface Details, Loading Details, Budget Pricing, Bids.

DoorEngineering.com
800.959.1352



— A SENNECA COMPANY —

Opening to Your Standards

Door Engineering A Senneca Company
101 Power Drive, Mankato, MN 56001

DE-AV-H-SS-081125

DoorEngineering.com
800.959.1352

