



# INSTALLATION & SERVICE MANUAL

## PASS THRU HEAVY DUTY HINGE DOOR

---



# Table of Contents

1. Location of Parts
2. Door Installation
3. Add Torque to Hinges

## Safety and Warnings



### **BEFORE YOU BEGIN**

Read instructions completely and carefully.

### **WARNING: TO REDUCE THE RISK OF FIRE, ELECTRICAL SHOCK OR INJURY, OBSERVE THE FOLLOWING:**

- 1) Use this unit in the manner intended by the manufacturer.
- 2) Before servicing or altering, switch power off.



For use inside a commercial refrigeration case with packaged foods only.

### **FOR YOUR SAFETY**

Read and observe all CAUTIONS and WARNINGS shown throughout these instructions. While performing installations described; gloves, safety glasses or goggles should be worn.



### **PREPARE ELECTRICAL WIRING**

#### **Electrical requirements**

This appliance must be supplied with 120V, 60 Hz, and connected to an individual and properly grounded branch circuit, protected by a 15 or 20 ampere circuit breaker or time delay fuse.

#### **Grounding Instructions – Cable Direct**

This lighting system must be connected to a grounded metal, permanent wiring system, or an equipment grounding connector must be run with the system conductors and be connected to the equipment grounding terminal or lead on the lighting fixture.

## 1. Location of Parts

1.1. When installing heavy duty pass thru doors, make sure the hinges are in their proper locations. You should see spring hinges on the top and bottom of the door. The spring hinges will require torque to be applied after the door is installed. A regular standard butt hinge should be located in the middle position.

### 1.1.1. Hinges

1.1.1.1. 4 holes on the frame side and 2 holes on the door side.

1.1.1.2. 3 QTY LBR-9942-200 Self Closing SS Hinge

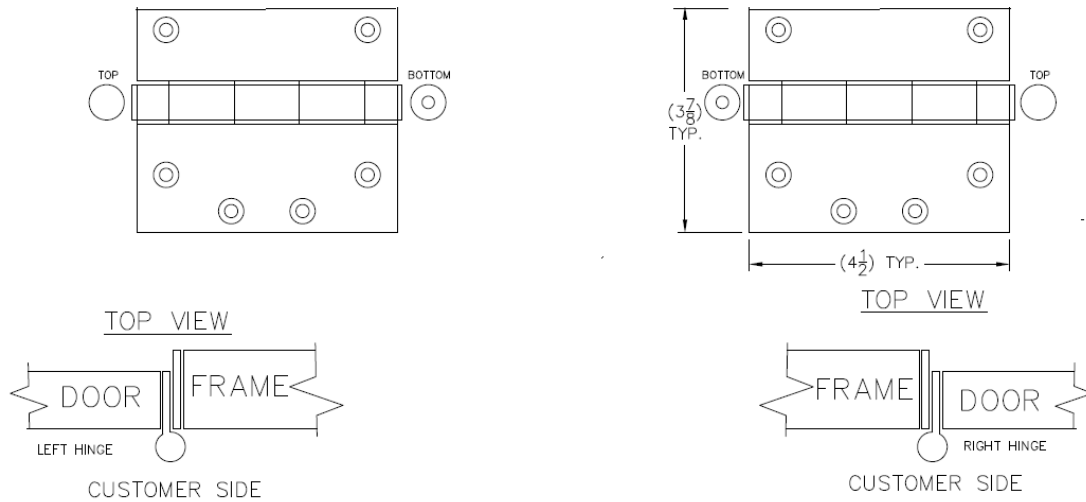

**Note:** there are right hand and left hand hinges

1.2. Two people are required when installing heavy duty hinge door. For support and balance, it is easier to use some 2 x 4's to position the door onto the frame during installation.



### 1.3. Confirmation of Parts

All remaining parts required to install the door(s) are shipped along with the frame assembly. Quantities of parts will differ, depending on the number of doors installed. You should receive (6) 12-24 screws (1/2" in length), (2) torque spring hinge pins and (1) torque wrench per hinge. The pins and wrench are only needed to add torque to the spring hinges when the door is completely installed.



## Door Installation

- 1.4. Align the door with the frame using 2 x 4's for support. Align and install screws to the middle position hinge first. Do not screw all the way in until other hinges are in place. After the middle position is in place, ensure the door does not hang from the middle hinge. Always maintain door weight balance.



- 1.5. Next, align either top or bottom spring hinge. Repeat step 1 process and tighten all screw positions on all hinges. (Use shims provided as needed to get the door to close naturally).

**\*\*\*\*NOTE: TIGHTENING SCREWS MAXIMUM TORQUE 28 IN/LBS\*\*\*\***



**Shim**

## 1.6. Hold Open

Once all hinges are in place and screwed on, install the hold open. Position the hold open onto the pivot and screw on tightly. Once the hold open is in place, ensure everything closes and opens with ease. If not, ensure all hinges are correctly placed and screws are fully tight. If the door does not close with ease, adjust the height of the bottom flap by loosening the screws and adjusting the height. When the door is properly in place, torque must be added to the hinges.



## 2. Add Torque to Hinges

2.1. With wrench key in hand, rotate the adjustment capstan clockwise. Rotate the pin approximately 1.5 turns, until the fourth hole is reached.



Once at the fourth hole, insert the stopper pin and remove the wrench key.



After both pins are in, check the door closing tension. To achieve proper door closing force, move the tension stopper pin from one hole into the next, in either direction, by using the wrench key.

Note : Top and Bottom hinge need to be torqued equally .

## Revisions

<u>Rev.</u>	<u>Description</u>	<u>Date</u>	<u>Orig.</u>	<u>Inc.</u>	<u>Chk.</u>
A	PRODUCTION RELEASE	12/12/25	HT	HT	