

# FCG-1 ORDER FROM

Quote/Order# \_\_\_\_\_

Company Name: \_\_\_\_\_

Attention: \_\_\_\_\_

Email: \_\_\_\_\_

Phone#: \_\_\_\_\_

Job Name: \_\_\_\_\_

## PAIR

## SINGLE

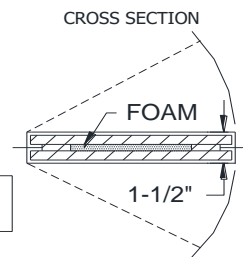
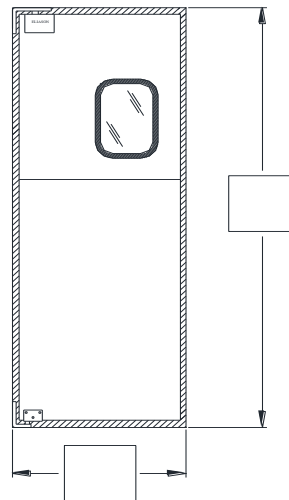
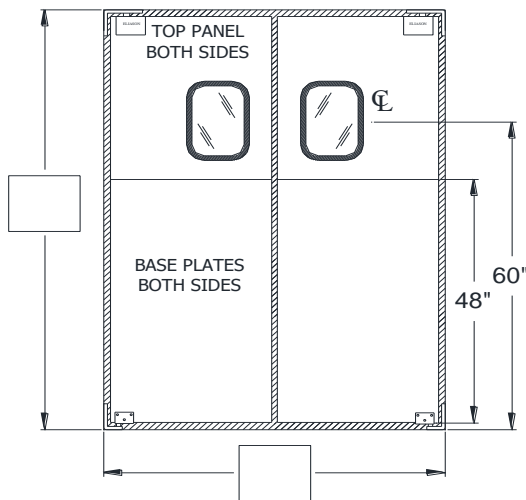

\* Single Leaf-- Specify Left or Right Hinge



Fill in Opening Size in the Blanks Provided Above

**STANDARD SPECIFICATIONS:** Door body is a 1-1/2" composite wood inner door frame with foam core (No foam on door widths 23" and under), fully gasketed, metal clad. Full height stainless steel panels, both sides including hinge covers. 9" x 14" clear acrylic safety window set in black rubber molding. Door assembly includes the original "NO SPRING" Easy Swing® hinges and both 1/4" - 20 x 1" thread cutting screws and #14 -1-1/2" sheet metal/wood screws for jamb by others.

**INSTALLATION DETAILS:** Jambs must be plumb and square. Minimum double 2 x 4 inch wood construction or equivalent. Hollow metal jambs should be reinforced at hinge locations.

### SPECIFIC DETAILS FOR DOOR CONSTRUCTION:

HANDING: ☐ Left ☐ Right ☐ Pair

WINDOW: ☐ Standard 9" X 14" In Black Rubber Molding, Up 60" to Center of Window from Floor  
☐ Other: \_\_\_\_\_

JAMB GUARD: ☐ 3" X 9" ☐ 5" X 18" ☐ None

PLATE: Specify Height: \_\_\_\_\_  
 Color/Material: ☐ Stainless Steel ☐ Galvanized Steel ☐ Black ABS ☐ Other \_\_\_\_\_

BUMPER: Standard Black Tear Drop Polyethylene, Height: ☐ 12 ☐ 18 ☐ 24 ☐ 30 ☐ 36 ☐ 42  
 Aluminum Bumper Strip: ☐

OTHER SPECIFICATIONS: \_\_\_\_\_

APPROVED BY: \_\_\_\_\_

DATE: \_\_\_\_\_

Eliason Corporation